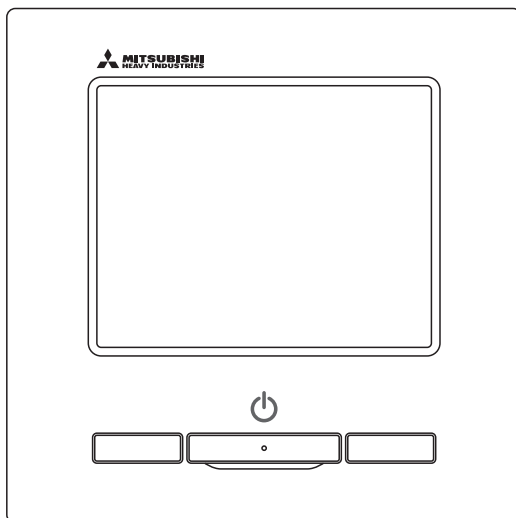

# REMOTE CONTROL RC-EXZ3A

## QUICK REFERENCE

Quick reference **ENGLISH**Kurzanleitung **DEUTSCH**Aide-mémoire **FRANÇAIS**Consulta rápida **ESPAÑOL**Guida rapida di riferimento **ITALIANO**Beknopte handleiding **NEDERLANDS**Краткое руководство **РУССКИЙ**

This air conditioner complies with following directive.

Machinery 2006 / 42 / EC  
 Low voltage 2014 / 35 / EU  
 EMC 2014 / 30 / EU  
 RoHS 2011 / 65 / EU  
 Ecodesign 2009 / 125 / EC  
 CE making is applicable to area of 50Hz power supply.

Ce climatiseur est conforme aux directives suivantes :

Machinerie 2006 / 42 / EC  
 Basse tension 2014 / 35 / EU  
 EMC 2014 / 30 / EU  
 RoHS 2011 / 65 / EU  
 Conception écologique 2009 / 125 / EC

Le marquage CE est applicable dans les zones d'alimentation électrique de 50 Hz.

Questo condizionatore è conforme alle seguenti norme:

Macchine 2006 / 42 / EC  
 Bassa tensione 2014 / 35 / EU  
 EMC 2014 / 30 / EU  
 RoHS 2011 / 65 / EU  
 Ecoprogettazione 2009 / 125 / EC  
 La marcatura CE è applicabile all'area di alimentazione elettrica di 50Hz.

Данный кондиционер удовлетворяет нормам следующих директив:  
 по машинному оборудованию 2006 / 42 / EC

по низковольтному оборудованию 2014 / 35 / EU  
 EMC 2014 / 30 / EU  
 RoHS 2011 / 65 / EU  
 Ecodesign 2009 / 125 / EC  
 Маркировка CE применима к регионам с энергоснабжением с частотой 50 Гц.

Diese Klimaanlage entspricht den folgenden Richtlinien.  
 Maschinen 2006 / 42 / EC  
 Niederspannung 2014 / 35 / EU  
 EMC 2014 / 30 / EU  
 RoHS 2011 / 65 / EU  
 Ecodesign 2009 / 125 / EC  
 CE Herstellung ist in Bereich mit 50 Hz Stromversorgung anwendbar.

Este aire acondicionado cumple con las siguientes directrices.  
 Maquinaria 2006 / 42 / EC  
 Bajo voltaje 2014 / 35 / EU  
 EMC 2014 / 30 / EU  
 RoHS 2011 / 65 / EU  
 Ecodiseño 2009 / 125 / EC  
 La marca CE corresponde al área de suministro de energía de 60Hz.

Deze airconditioner voldoet aan de volgende richtlijn.  
 Machinerie 2006 / 42 / EC  
 Lage spanning 2014 / 35 / EU  
 EMC 2014 / 30 / EU  
 RoHS 2011 / 65 / EU  
 Ecodesign 2009 / 125 / EC  
 CE-markering is van toepassing op het gebied met een netstroom van 50 Hz.



# REMOTE CONTROL

## QUICK REFERENCE

### INSTALLATION

---

For the operation part of this Quick reference refer to page 21.

Refer to the “Installation manual” on the following web site for details.

[http://www.mhi-mth.co.jp/en/products/detail/air-conditioner\\_users\\_manual.html](http://www.mhi-mth.co.jp/en/products/detail/air-conditioner_users_manual.html)



### Contents

---

|   |  |    |
|---|--|----|
| ■ | 1. Safety precautions .....  | 2  |
| ■ | 2 . Accessories & Prepare on site .....                                  | 5  |
| ■ | 3 . Installation place .....   | 5  |
| ■ | 4 . Installation procedure .....   | 6  |
| ■ | 5 . Main/Sub setting when more than<br>one remote control are used ..... | 8  |
| ■ | 6 . Power on and initial setting.....                                    | 9  |
| ■ | 7 . Menu items .....   | 10 |
| ■ | 8 . Installation settings and test run .....                             | 11 |
| ■ | 9 . R/C function settings.....   | 14 |
| ■ | 10 . IU settings .....   | 16 |
| ■ | 11 . Service & Maintenance .....   | 19 |

# 1. Safety precautions

- Please read this manual carefully before starting installation work to install the unit properly. Every one of the followings is important information to be observed strictly.

|   |   |
|---|---|
|  <b>WARNING</b> | Failure to follow these instructions properly may result in serious consequences such as death, severe injury, etc. |
|  <b>CAUTION</b> | Failure to follow these instructions properly may cause injury or property damage.                                  |

It could have serious consequences depending on the circumstances.

- The following pictograms are used in the text.

|  |           |   |                                       |
|--|-----------|---|---------------------------------------|
|  | Never do. |  | Always follow the instructions given. |
|--|-----------|---|---------------------------------------|

- Keep this manual at a safe place where you can consult with whenever necessary. Show this manual to installers when moving or repairing the unit. When the ownership of the unit is transferred, this manual should be given to a new owner.

## WARNING



### **Consult your dealer or a professional contractor to install the unit.**

Improper installation made on your own may cause electric shocks, fire or dropping of the unit.



### **Installation work should be performed properly according to this installation manual.**

Improper installation work may result in electric shocks, fire or break-down.



### **Be sure to use accessories and specified parts for installation work.**

Use of unspecified parts may result in drop, fire or electric shocks.



### **Install the unit properly to a place with sufficient strength to hold the weight.**

If the place is not strong enough, the unit may drop and cause injury.



### **Be sure to have the electrical wiring work done by qualified electrical installer, and use exclusive circuit.**

Power source with insufficient and improper work can cause electric shock and fire.



### **Shut OFF the main power supply before starting electrical work.**

Otherwise, it could result in electric shocks, break-down or malfunction.



### **Do not modify the unit.**

It could cause electric shocks, fire, or break-down.



### **Be sure to turn OFF the power circuit breaker before repairing/ inspecting the unit.**

Repairing/inspecting the unit with the power circuit breaker turned ON could cause electric shocks or injury.

---

 **WARNING**

**Do not install the unit in appropriate environment or where inflammable gas could generate, flow in, accumulate or leak.**



If the unit is used at places where air contains dense oil mist, steam, organic solvent vapor, corrosive gas (ammonium, sulfuric compound, acid, etc) or where acidic or alkaline solution, special spray, etc. are used, it could cause electric shocks, break-down, smoke or fire as a result of significant deterioration of its performance or corrosion.

**Do not install the unit where water vapor is generated excessively or condensation occurs.**



It could cause electric shocks, fire, or break-down.

**Do not use the unit in a place where it gets wet, such as laundry room.**



It could cause electric shocks, fire, or break-down.

**Do not operate the unit with wet hands.**



It could cause electric shocks.

**Do not wash the unit with water.**



It could cause electric shocks, fire, or break-down.

**Use the specified cables for wiring, and connect them securely with care to protect electronic parts from external forces.**



Improper connections or fixing could cause heat generation, fire, etc.

**Seal the inlet hole for remote control cable with putty.**



If dew, water, insect, etc. enters through the hole, it could cause electric shocks, fire or break-down.

If dew or water enters the unit, it may cause screen display anomalies.

**When installing the unit at a hospital, telecommunication facility, etc., take measures to suppress electric noises.**



It could cause malfunction or break-down due to hazardous effects on the inverter, private power generator, high frequency medical equipment, radio communication equipment, etc.

The influences transmitted from the remote control to medical or communication equipment could disrupt medical activities, video broadcasting or cause noise interference.

**Do not leave the remote control with its upper case removed.**



If dew, water, insect, etc. enters through the hole, it could cause electric shocks, fire or break-down.

---

---

## ⚠ CAUTION

### **Do not install the remote control at following places.**

- 
- (1) It could cause break-down or deformation of remote control.
    - Where it is exposed to direct sunlight
    - Where the ambient temperature becomes 0 °C or below, or 40 °C or above
    - Where the surface is not flat
    - Where the strength of installation area is insufficient
  - (2) Moisture may be attached to internal parts of the remote controller, resulting in a display failure.
    - Place with high humidity where condensation occurs on the remote controller
    - Where the remote controller gets wet
  - (3) Accurate room temperature may not be detected using the temperature sensor of the remote controller.
    - Where the average room temperature cannot be detected
    - Place near the equipment to generate heat
    - Place affected by outside air in opening/closing the door
    - Place exposed to direct sunlight or wind from air conditioner
    - Where the difference between wall and room temperature is large

---

### **To connect to a personal computer via USB, use the dedicated software.**



### **Do not connect other USB devices and the remote controller at the same time.**

It could cause malfunction or break-down of the remote controller/personal computer.

---

## 2 . Accessories & Prepare on site

Following parts are provided.

|             |  |
|-------------|--|
| Accessories | R/C main unit, wood screw (ø3.5 x 16) 2 pcs, Quick reference |
|-------------|--|

Following parts are arranged at site. Prepare them according to the respective installation procedures.

| Item name  | Q'ty        | Remark   |
|--|-------------|--|
| Switch box<br>For 1 piece or 2 pieces (JIS C8340 or equivalent)                              | 1           | These are not required when installing directly on a wall. |
| Thin wall steel pipe for electric appliance directly on a wall.<br>(JIS C8305 or equivalent) | As required |  |
| Lock nut, bushing (JIS C8330 or equivalent)  | As required |  |
| Lacing (JIS C8425 or equivalent)   | As required | Necessary to run R/C cable on the wall.                    |
| Putty  | Suitably    | For sealing gaps   |
| Molly anchor   | As required |  |
| R/C cable (0.3 mm <sup>2</sup> x 2 pcs)  | As required | See right table when longer than 100 m                     |

When the cable length is longer than 100 m, the max size for wires used in the R/C case is 0.5 mm<sup>2</sup>. Connect them to wires of larger size near the outside of R/C. When wires are connected, take measures to prevent water, etc. from entering inside.

|         |                               |
|---------|-------------------------------|
| ≤ 200 m | 0.5 mm <sup>2</sup> x 2-core  |
| ≤ 300m  | 0.75 mm <sup>2</sup> x 2-core |
| ≤ 400m  | 1.25 mm <sup>2</sup> x 2-core |
| ≤ 600m  | 2.0 mm <sup>2</sup> x 2-core  |

## 3 . Installation place

Secure the installation space shown in the figure.  
For the installation method, "embedding wiring" or "exposing wiring" can be selected.  
For the wiring direction, "Backward", "Upper center" or "Upper left" can be selected.  
Determine the installation place in consideration of the installation method and wiring direction.

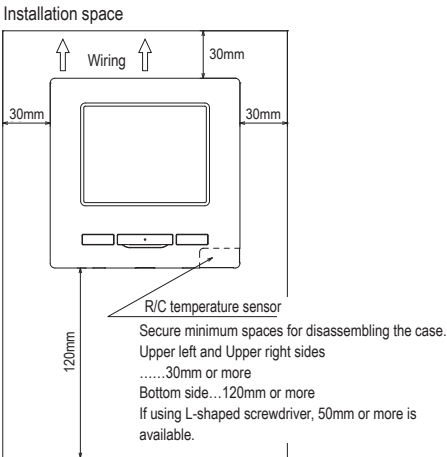

\_\_\_\_\_

- ③ Connect wires from X and Y terminals of R/C to X and Y terminals of indoor unit. R/C wires (X, Y) have no polarity. Fix wires such that the wires will run around the terminal screws on the top case of R/C.

- ④ Install the upper case with care not to pinch wires of R/C.

#### Cautions for wire connection

Use wires of no larger than 0.5 mm<sup>2</sup> for wiring running through the remote control case. Take care not to pinch the sheath.

Tighten by hand (0.7 N·m or less) the wire connection. If the wire is connected using an electric driver, it may cause failure or deformation.

#### In case of exposing wiring

(When the wiring is taken out from the "upper center" or "upper left" of R/C)

- ① Cut out the thin wall sections on the cases for the size of wire.

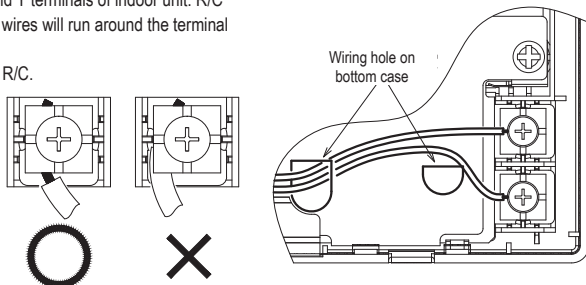

When taking the wiring out from the upper center, open a hole before separating the upper and bottom cases. This will reduce risk of damaging the PCB and facilitate subsequent work.

When taking the wiring out from the upper left, take care not to damage the PCB and not to leave any chips of cut thin wall inside.

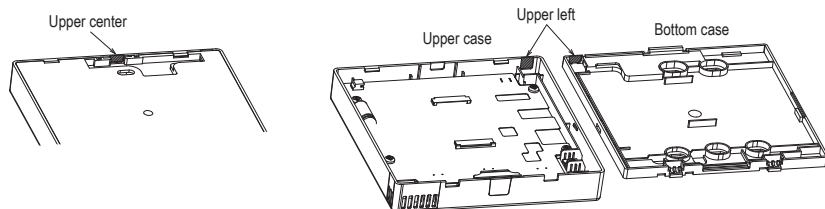

- ② Fix the bottom R/C case on a flat surface with two wood screws.
- ③ In case of the upper center, pass the wiring behind the bottom case. (Hatched section)
- ④ Connect wires from X and Y terminals of R/C to X and Y terminals of indoor unit. R/C wires (X, Y) have no polarity. Fix wires such that the wires will run around the terminal screws on the top case of R/C.
- ⑤ Install the top case with care not to pinch wires of R/C.
- ⑥ Seal the area cut in ① with putty.

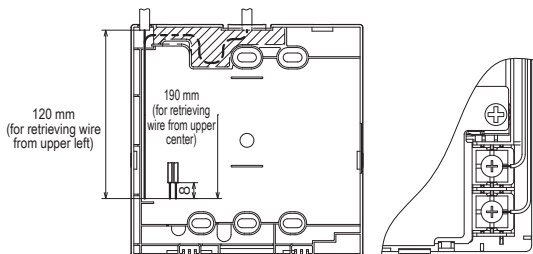

## 5. Main/Sub setting when more than one remote control are used

Up to two units of R/C can be used at the maximum for 1 indoor unit or 1 group.

One is main R/C and the other is sub R/C.

Operating range is different depending on the main or sub R/C.

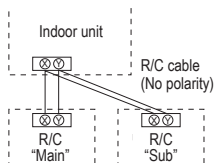

Set the "Main" and "Sub" as described at Section 8.

| R/C operations  |                         | Main                           | Sub |   |
|---|-------------------------|--------------------------------|-----|---|
| Run/Stop, Change set temp, Change flap direction, Auto swing, Change fan speed operations |                         | ○                              | ○   |   |
| High power operation, Energy-saving operation   |                         | ○                              | ○   |   |
| Silent mode control   |                         | ○                              |     |   |
| Useful functions  | Individual flap control | ○                              | ×   |   |
|   | Anti draft setting      | ○                              | ×   |   |
|   | Timer                   | ○                              | ○   |   |
|   | Favorite setting        | ○                              | ○   |   |
|   | Weekly timer            | ○                              | ×   |   |
|   | Home leave mode         | ○                              | ×   |   |
|   | External ventilation    | ○                              | ○   |   |
|   | Select the language     | ○                              | ○   |   |
| Silent mode control   |                         | ○                              | ×   |   |
| Energy-saving setting   |                         | ○                              | ×   |   |
| Filter  | Filter sign reset       | ○                              | ○   |   |
| User setting  | Initial settings        |                                | ○   | ○ |
|   | Administrator settings  | Permission/Prohibition setting | ○   | × |
|   |                         | Outdoor unit silent mode timer | ○   | × |
|   |                         | Setting temp range             | ○   | × |
|   |                         | Temp increment setting         | ○   | × |
|   |                         | Set temp display               | ○   | ○ |
|   |                         | R/C display setting            | ○   | ○ |
|   |                         | Change administrator password  | ○   | ○ |
| F1/F2 function setting  |                         | ○                              | ○   |   |

○: operable ×: not operable

| R/C operations     |                              | Main                       | Sub             |   |   |
|--------------------|------------------------------|----------------------------|-----------------|---|---|
| Service setting    | Installation settings        | Installation date          | ○               | × |   |
|                    |                              | Company information        | ○               | ○ |   |
|                    |                              | Test run                   | ○               | × |   |
|                    |                              | Duct unit settings         | ○               | × |   |
|                    |                              | Change auto-address        | ○               | × |   |
|                    |                              | Address setting of main IU | ○               | × |   |
|                    |                              | IU back-up function        | ○               | × |   |
|                    |                              | Motion sensor setting      | ○               | × |   |
|                    |                              | R/C function settings      | Main/Sub of R/C | ○ | ○ |
|                    | Return air temp              |                            | ○               | × |   |
|                    | R/C sensor                   |                            | ○               | × |   |
|                    | R/C sensor adjustment        |                            | ○               | × |   |
|                    | Operation mode               |                            | ○               | × |   |
|                    | °C / °F                      |                            | ○               | × |   |
|                    | Fan speed                    |                            | ○               | × |   |
|                    | External input               |                            | ○               | × |   |
|                    | Upper/lower flap control     |                            | ○               | × |   |
|                    | Left/right flap control      |                            | ○               | × |   |
|                    | Ventilation setting          |                            | ○               | × |   |
|                    | Auto-restart                 |                            | ○               | × |   |
|                    | Auto temp setting            |                            | ○               | × |   |
|                    | Auto fan speed               |                            | ○               | × |   |
|                    | IU settings                  |                            |                 | ○ | × |
|                    | Service & Maintenance        |                            | IU address      | ○ | ○ |
|                    |                              | Next service date          | ○               | × |   |
| Operation data     |                              | ○                          | ×               |   |   |
| Error display      |                              | Error history              | ○               | ○ |   |
|                    |                              | Display/erase anomaly data | ○               | × |   |
|                    |                              | Reset periodical check     | ○               | ○ |   |
| Saving IU settings |                              | ○                          | ×               |   |   |
| Special settings   |                              | Erase IU address           | ○               | × |   |
|                    |                              | CPU reset                  | ○               | ○ |   |
|                    |                              | Restore of default setting | ○               | × |   |
|                    | Touch panel calibration      | ○                          | ○               |   |   |
|                    | Indoor unit capacity display | ○                          | ×               |   |   |

### Advice: Connection to personal computer

It can be set from a personal computer via the USB port (mini-B).

Connect after removing the cover for USB port of upper case.

Replace the cover after use.

Special software is necessary for the connection.

For details, view the web site or refer to the engineering data.

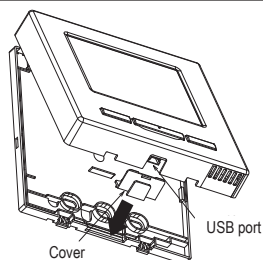

### Advice: Initializing of password

Administrator password (for daily setting items) and service password (for installation, test run and maintenance) are used.

- The administrator password at factory default is "0000". This setting can be changed (Refer to User's Manual).

If the administrator password is forgotten, it can be initialized by holding down the [F1] and [F2] switches together for five seconds on the administrator password input screen.

- Service password is "9999", which cannot be changed.

When the administrator password is input, the service password is also accepted.

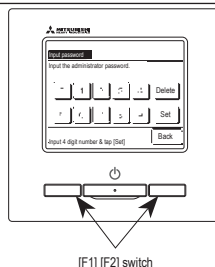

### Advice

When connecting two or more FDT/FDTC to one R/C, unify the panel type either to a panel with anti draft function or a standard panel.

## 6 . Power on and initial setting

Set the main and sub R/C units according to the display at the power on.

- Main/Sub setting not performed => (1)
- Main/Sub setting performed => (2)

### (1) When the main and sub are not yet set,

①⇒② Main/sub input screen is displayed.

When tapping the **Main** or **Sub** button, initial setting starts.

If any wrong button has been tapped by mistake, the setting can be changed after the end of the initializing operation. (10. R/C function setting④)

When using two remote controllers for one IU or one group, if the first one is set for the **Main**, the second is set for the **Sub** automatically.

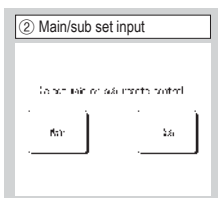
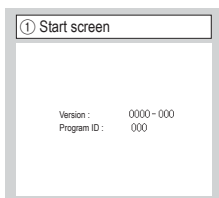

### Caution

When only one unit of R/C is used, tap the **Main** button. In the state of initial setting, if either one of buttons ([Main]/[Sub]) is not tapped, it keeps the screen unchanged.

**Main** The screen changes to ③⇒④⇒⑤.

**Sub** The screen changes to ①⇒⑧⇒⑤.

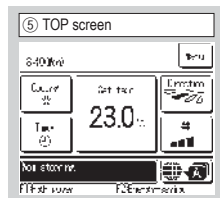
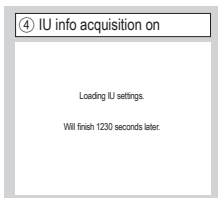
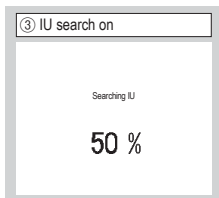

The red LED will blink if communication is not established in ten minutes.

### (2) When the main and sub are set

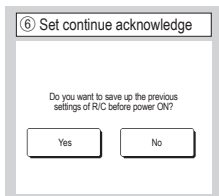

**Yes** The screen changes to ⑧⇒⑤.

**No** The screen changes to ⑦.

If the screen is not tapped for more than 15 seconds, the **Yes** (Continue) is selected and the display changes to the screen of ⑤.

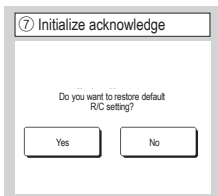

**Yes** The screen changes to ①⇒②.

**No** The screen changes to ⑥.

After the initializing, it returns to the default state.

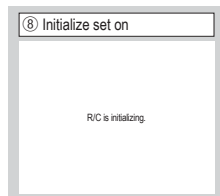

**Yes** The screen changes to ①⇒②.

**No** The screen changes to ⑥.

After the initializing, it returns to the default state.

## 7 . Menu items

|   |                              |
|---|------------------------------|
| <b>Main menu</b>                            |                              |
| Basic operation                             | Refer to user's manual       |
| Useful functions                            | Refer to user's manual       |
| Energy-saving setting                       | Refer to user's manual       |
| Filter                                      | Refer to user's manual       |
| User setting                                | Refer to user's manual       |
| Service setting                             |                              |
| Installation settings                       |                              |
| Installation date                           | 11                           |
| Company information                         | 11                           |
| Test run                                    | 11                           |
| Duct unit settings                          | 11                           |
| Change auto-address                         | 12                           |
| Address setting of main IU                  | 13                           |
| IU back-up function                         | 13                           |
| Motion sensor setting                       | 13                           |
| R/C function settings                       |                              |
| Main/Sub of R/C                             | 14                           |
| Return air temp                             | 14                           |
| R/C sensor                                  | 14                           |
| R/C sensor adjustment                       | 14                           |
| Operation mode                              | 14                           |
| °C / °F                                     | 15                           |
| Fan speed                                   | 15                           |
| External input                              | 15                           |
| Upper/lower flap control                    | 15                           |
| Left/right flap control                     | 15                           |
| Ventilation setting                         | 15                           |
| Auto-restart                                | 15                           |
| Auto temp setting                           | 15                           |
| Auto fan speed                              | 15                           |
| IU settings                                 |                              |
| Fan speed setting                           | 16                           |
| Filter sign                                 | 16                           |
| External input 1                            | Refer to Installation manual |
| External input 1 signal                     | Refer to Installation manual |
| External input 2                            | Refer to Installation manual |
| External input 2 signal                     | Refer to Installation manual |
| Heating thermo-OFF temp adjustment          | 16                           |
| Return temperature adjustment               | 16                           |
| Fan control in cooling thermo-OFF           | 16                           |
| Fan control in heating thermo-OFF           | 17                           |
| Anti-frost temp                             | Refer to Installation manual |
| Anti-frost control                          | Refer to Installation manual |
| Drain pump operation                        | 17                           |
| Keep fan operating after cooling is stopped | 17                           |
| Keep fan operating after heating is stopped | 17                           |
| Intermittent fan operation in heating       | 17                           |
| Fan circulator operation                    | 17                           |
| Control pressure adjust                     | 17                           |
| Auto operation mode                         | 18                           |
| Thermo. rule setting                        | 18                           |
| Auto fan speed control                      | 18                           |
| IU overload alarm                           | 18                           |
| External output setting                     | Refer to Installation manual |
| Service & Maintenance                       |                              |
| IU address                                  | 19                           |
| Next service date                           | 19                           |
| Operation data                              | 19                           |
| Error display                               | 20                           |
| Saving IU settings                          | 20                           |
| Special settings                            | 20                           |
| Indoor unit capacity display                | 20                           |
| Contact company                             | Refer to user's manual       |

## 8 . Installation settings and test run

TOP screen  ⇒  ⇒  ⇒

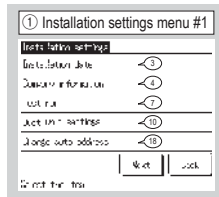

The selected screen is displayed.

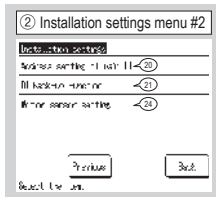

The selected screen is displayed.

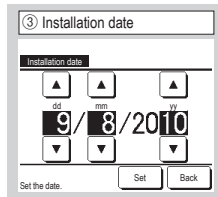

Select the date with   buttons, and tap the  button.

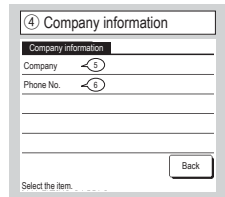

Enter the company information.

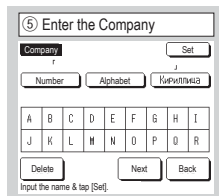

Enter the company name using up to 26 one-byte characters and then tap the  button. You can enter alphanumeric or Cyrillic.



Enter the phone number of the company using up to 13 characters and then tap the  button.

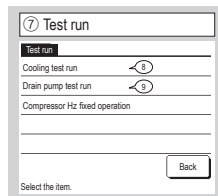

The selected screen is displayed.

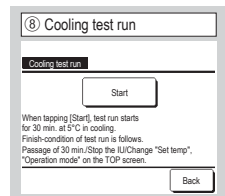

This can be operated while cooling is stopped. When the room temperature is too low to start the cooling test run, it operates for 30 minutes by decreasing the set temperature to 5°C.

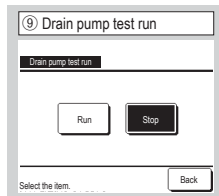

Drain pump can be operated independently.

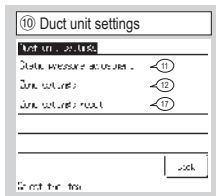

**Static pressure adjustment** : Performs external static pressure Adjustment for the duct unit.  
**Zone settings** : Set when performing zone control.  
**Zone settings reset** : Resets all zone settings.

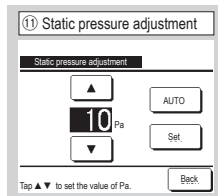

This is operable in case of connecting duct type IU equipped with the external static pressure adjustment function. Select the external static pressure and tap the  button.

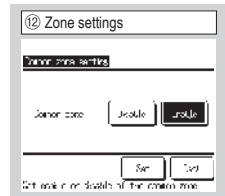

Set when performing zone control.  
 Set whether or not there is a common zone.  
 (Enable: Present, Disable: Not present)  
 A common zone is a zone in which a damper is not installed.

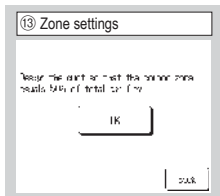

Design the duct so that the common zone equals 50% of total air flow.

If this is acceptable, tap the **OK** button.

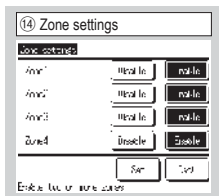

Set the existence of zones 1 to 4. (Enable: Present, Disable: Not present)

Zones 1 to 3 can be set when setting common zones.

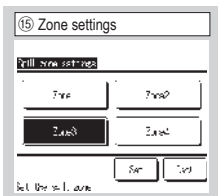

Select a Spill zone.

Zones set as spill zones will automatically open if the spill zone is closed and one or more other zone are closed.

Spill zone selection is required when there is no common zone. This screen will not be displayed if there is a common zone.

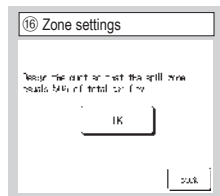

Design the duct so that the spill zone equals 50% of total air flow.

If this is acceptable, tap the **OK** button.

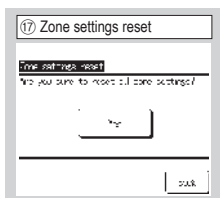

Resets all zone settings.

If this is acceptable, tap the **Yes** button.

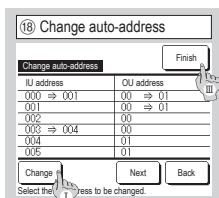

In case of Multi series (KX) models, the IU addresses registered with the auto-address setting method can be changed with this function.

This function changes the OU address for each IU. Select an IU and,

- I When an indoor unit is selected and the **Change** button is tapped, the display changes to the Change auto-address screen 19.
- II Tap the **Set** button to return to the screen 18 and display the new address.
- III Tap the **Finish** button to register the new address.

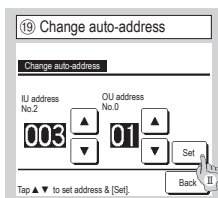

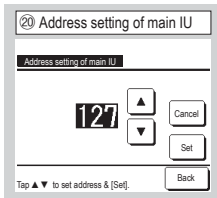

In case of Multi Series (KX) models, it is possible to let indoor units (Sub IUs) follow the operation mode (Heating, cooling) of the indoor unit (Main IU). Set the address of the Main IU to the Sub IUs. The Sub IUs to which the Main IU address is set follow the Main IU settings.

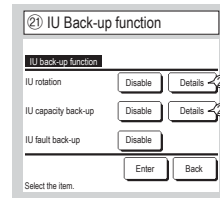

In case of 2 sets of indoor units (2 groups) connected to one R/C, it is available to perform back-up operation with them.

1. IU rotation: Operate 2 sets of indoor units alternately at every set time of operation interval.
2. IU capacity back-up: When the temp difference between the set temp and the actual room temp is higher than the set temp diff., 2 sets of indoor units operate.
3. IU fault back-up: If one of the IU has a fault and stops, the other one starts operation.

Select **Enable** / **Disable** (tapping **Disable** changes to **Enable**) and tap the **Enter** button to confirm the settings.

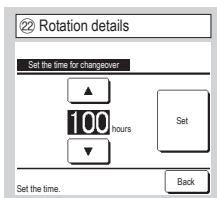

In IU rotation function, the timer to changeover the operation of 2 indoor units is set.  
The timer can be set within the range of 1 to 999 hours in increments of one hour.

After the time is changed, tap **Set** for temporary setting.

After temporary setting, return to the IU Back-up function screen and tap **Enter**.

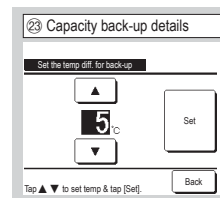

The difference between the setting temperature for a change between one unit and two units for capacity back-up and room temperature is set.

The temperature can be set within the range of 2 to 5 °C in increments of 1 °C.

After the temperature is changed, tap **Set** for temporary setting. After temporary setting, return to the IU Back-up function screen and tap **Enter**.

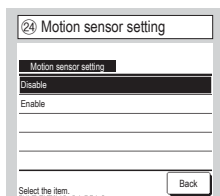

Select **Enable** / **Disable** for the motion sensor of the indoor unit connected to the R/C.

- For customers who adapt a motion sensor, please proceed the setting shown on the left and enable the indoor unit to be used to detect the activity amounts of persons. When the motion sensor is disabled, activity amounts of persons will not be detected and thus the motion sensor control (power saving and auto-off) will not be performed.
- For indoor units without a motion sensor, tap the Motion sensor setting to display "Invalid request".

## 9. R/C function settings Advice: It is valid when unit stops.

TOP screen Menu ⇒ Service setting ⇒ R/C function settings ⇒ Service password

① R/C function settings menu #1

**R/C function settings**

Main/Sub of R/C ◀4

Return air temp ◀5

R/C sensor ◀6

R/C sensor adjustment ◀7

Operation mode ◀10

Select the item. Next Back

The selected screen is displayed.

② R/C function settings menu #2

**R/C function settings**

°C / °F ◀11

Fan speed ◀12

External input ◀13

Upper/lower flap control ◀14

Left/right flap control ◀15

Select the item. Previous Next Back

③ R/C function settings menu #3

**R/C function settings**

Ventilation setting ◀16

Auto-restart ◀17

Auto temp setting ◀18

Auto fan speed ◀19

Select the item. Previous Back

④ Main/Sub of R/C

**Main/Sub of R/C**

Main ◀

Sub ◀

Select the item. Back

Use this when changing the Main/Sub setting of R/C.

⑤ Return air temp

**Return air temp**

Individual ◀

Master IU ◀

Averaged temp ◀

Select the item. Back

Thermo. rule is applied based on the temperature detected with the return air temp sensor of IU.  
When plural indoor units are connected to one R/C, the return air temp applied to the thermo. rule can be selected.

1. **Individual** : Thermo. rule is applied based on the return air temp of each IU. When plural units are connected to one R/C, it is based on the return air temp of the main unit.
2. **Master IU** : Thermo. rule is applied based on the return air temp of IU having the youngest address out of IUs connected.  
If there are several sets of plural units each of which is connected to one R/C, it is based on the IU having the youngest address out of the main units of each plural units.
3. **Averaged temp** : Thermo. rule is applied based on the average of return air temperatures of IUs connected.

⑥ R/C sensor

**R/C sensor**

Disable ◀

Enable ◀

Enable(Heating only) ◀

Enable(Cooling only) ◀

Select the item. Back

You can change IU main unit return air temperature sensor to the R/C side.

- Disable The Indoor temp display changes to the temperature measured by the sensor at the main unit.
- Enable The Indoor temp display changes to the temperature measured by the R/C side sensor.
- Enable(Heating only) The Indoor temp display changes to the temperature measured by the R/C side sensor during heating only.
- Enable(Cooling only) The Indoor temp display changes to the temperature measured by the R/C side sensor during cooling only.

⑦ R/C sensor adjustment

**R/C sensor adjustment**

Adjustment in cooling ◀8

Adjustment in heating ◀9

Select the item. Back

You can adjust the R/C sensor detection temperature.

- Adjustment in cooling ⇒ ⑧
- Adjustment in heating ⇒ ⑨

⑧ Adjustment in cooling

**Adjustment in cooling**

Tap ▲ ▼ to set offset value.

+1 °C ▲ ▼ Set

Back

The R/C sensor detection temperature during cooling operation can be corrected.  
Set the value within the range of -3 to +3.

⑨ Adjustment in heating

**Adjustment in heating**

Tap ▲ ▼ to set offset value.

0 °C ▲ ▼ Set

Back

The R/C sensor detection temperature during heating operation can be corrected.  
Set the value within the range of -3 to +3.

⑩ Operation mode

**Operation mode**

Auto Disable Enable

Cooling Disable Enable

Heating Disable Enable

Dry Disable Enable

Select the item. Set Back

Enable or Disable can be set for each operation mode.  
If the cooling or heating is disabled, the auto is also disabled.

Select the unit of temperature displayed on the R/C.

Fan speed can be changed to the selected one.  
It may not be available to select some of fan speeds depending on indoor unit models.

Set the range to apply the external input received through CNT of either one IU to plural indoor units connected in one system

- Individual** This is applied only to the IU receiving CNT input.
- All units** This is applied to all indoor units connected.

**Stop at fixed position** The upper/lower flap can be set to stop at one of four positions.

**Stop at any position** The flap can be set to stop at any position immediately after operating the R/C switch.

**Fixed position stop** The left/right flap can be set to stop in eight different patterns.

**Stop at any position** The flap can be set to stop at any position immediately after operating the R/C switch.

Set this when a ventilation device is connected.

- Disable** No ventilation device is connected.
- Interlocking** Ventilation is interlocked with the Run/Stop of air conditioner and operate the Ventilation output.
- Independent** If the ventilation is selected from the menu, only the ventilation device is operated or stopped independently.

If the unit stops during operation,

- Enable** It returns to the state before the power failure as soon as the power supply is restored (After the end of the primary control at the power on).
- Disable** It stops after the restoration of power supply.

- Enable** Auto can be selected on the room temperature setting screen.
- Disable** Auto selection switch will not be displayed on the room temperature setting screen.

- Enable** Auto can be selected on the fan speed setting screen.
- Disable** Auto selection switch will not be displayed on the fan speed setting screen.

# 10 . IU settings

**Advice: It is valid when unit stops.**

TOP screen  ⇒  ⇒  ⇒

① IU select #1

**IU select**

|     |     |     |     |
|-----|-----|-----|-----|
| 000 | 001 | 002 | 003 |
| 004 | 005 | 006 | 007 |

Select an IU address.

② IU select #2

**IU select**

|     |     |     |     |
|-----|-----|-----|-----|
| 008 | 009 | 010 | 011 |
| 012 | 013 | 014 | 015 |

Select an IU address.

③ Loading

Loading. Wait a while.



④ IU setting menu #1

**IU settings**

Fan speed setting

Filter sign

External input 1

External input 1 signal

External input 2

Select the item.

When plural indoor units are connected, they are displayed on the screen.

to  Individual settings are performed for indoor units.  
 The same setting applies to all units.

The display changes to ④ after receiving data from the IU.

The selected screen is displayed.

⑤ IU setting menu #2

**IU settings**

External input 2 signal

Heating thermo-OFF temp adjustment

Return temperature adjustment

Fan control in cooling thermo-OFF

Fan control in heating thermo-OFF

Select the item.

⑥ IU setting menu #3

**IU settings**

Anti-frost temp

Anti-frost control

Drain pump operation

Keep fan operating after cooling is stopped

Keep fan operating after heating is stopped

Select the item.

⑦ IU setting menu #4

**IU settings**

Intermittent fan operation in heating

Fan circulator operation

Control pressure adjust

Auto operation mode

Thermo. rule setting

Select the item.

⑧ IU setting menu #5

**IU settings**

Auto fan speed control

IU overload alarm

External output setting

Select the item.

⑨ Fan speed setting

**Fan speed setting**

Standard

Setting 1

Setting 2

Select the item.

⑩ Filter sign

**Filter sign**

No display

Setting 1

Setting 2

Setting 3

Setting 4

Select the item.

|            | Standard               |
|------------|------------------------|
| No display | None                   |
| Setting 1  | 180Hr                  |
| Setting 2  | 600Hr                  |
| Setting 3  | 1,000Hr                |
| Setting 4  | 1,000Hr Operation stop |

Set the fan speed tap for the IU.  
Refer to the engineering data for details.

Set the time to display the filter sign.

⑪ Heating thermo-OFF temp adjustment

**Heating thermo-OFF temp adjustment**

Tap ▲▼ to set offset value.

**+2.0** °C

Adjust the temperature for judging to make thermostat ON or OFF during heating operation.  
Adjustable range is 0°C / +1°C / +2°C / +3°C.

⑫ Return temperature adjustment

**Return temperature adjustment**

Tap ▲▼ to set offset value.

**+1.5** °C

Adjust the main return air temperature sensor detection temperature.  
Adjustable range is -2°C / -1.5°C / -1°C / 0°C / +1°C / +1.5°C / +2°C.

⑬ Fan control in cooling thermo-OFF

**Fan control in cooling thermo-OFF**

Low

Set fan speed

Intermittent

Stop

Select the item.

Set the fan speed at the cooling thermo-OFF.

The fan runs at the low speed.

The fan runs at the same speed as that during the thermo-ON operation.

Cycles of Lo fan operation for 2 minutes and stop for 5 minutes are repeated.

The fan is stopped.

⑭ Fan control in heating thermo-OFF

Fan control in heating thermo-OFF

Low

Set fan speed

Intermittent

Stop

Select the item. Back

Set the fan speed at the heating thermo-OFF.

**Low** The fan runs at the low speed.

**Set fan speed** The fan runs at the same speed as that during the thermo-ON operation.

**Intermittent** Cycles of Lo fan operation for 2 minutes and stop for 5 minutes are repeated.

**Stop** The fan is stopped.

⑮ Drain pump operation

Drain pump operation

Standard (in cooling & dry)

Operate in standard & heating

Operate in heating & fan

Operate in standard & fan

Select the item. Back

**Standard (in cooling & dry)** Operates in cooling and dry modes.

**Operate in standard & heating** Operates in cooling, dry and heating modes.

**Operate in heating & fan** Operates in all modes.

**Operate in standard & fan** Operates in cooling, dry and fan modes.

⑯ Keep fan operating after cooling is stopped

Keep fan operating after cooling is stopped

No setting

Setting 1

Setting 2

Setting 3

Select the item. Back

Select the residual fan operation time period after stopping and the thermo-OFF in cooling mode.

**No setting** Residual fan operation not performed.

**Setting 1** 0.5 hours

**Setting 2** 2 hours

**Setting 3** 6 hours

\*Residual time may vary.

⑰ Keep fan operating after heating is stopped

Keep fan operating after heating is stopped

No setting

Setting 1

Setting 2

Setting 3

Select the item. Back

Select the residual fan operation time period after stopping and the thermo-OFF in heating mode.

**No setting** Residual fan operation not performed.

**Setting 1** 0.5 hours

**Setting 2** 2 hours

**Setting 3** 6 hours

⑱ Intermittent fan operation in heating

Intermittent fan operation in heating

Stop

Stop for 20 min & run for 5 min

Stop for 5 min & run for 5 min

Select the item. Back

Select the fan control after the residual fan operation following stop and thermo-OFF in heating mode.

**Stop** Intermittent fan operation is not done.

**Stop for 20 min & run for 5 min** Check the operating conditions at every 25 min and run the fan for 5 min.

**Stop for 5 min & run for 5 min** Check the operating conditions at every 10 min and run the fan for 5 min.

⑲ Fan circulator operation

Fan circulator operation

Disable

Enable

Select the item. Back

Set this when operating the fan as a circulator.

**Disable** During the fan operation, the fan runs continuously.

**Enable** During the fan operation, the fan runs and stops based on the difference between temperatures detected with the R/C sensor and the return air sensor.

⑳ Control pressure adjust

Control pressure adjust

Standard

Type1

Select the item. Back

Set the control pressure when connecting the outdoor air conditioning unit to the Multi (KX) System.

**Standard** Normal

**Type1** When all operating IUs are in this mode, the control pressure value is changed.

**21 Auto operation mode**

Auto operation mode

Auto rule selection **22**

Auto 1 details

Auto 2 details

Auto 3 details

Select the item. Back

**22 Auto rule selection**

Auto rule selection

Auto 1

Auto 2

Auto 3

Select the item. Back

- Auto 1** The temp difference between the set temp and the actual room temp switch cooling and heating.
- Auto 2** The temp difference between the set temp and the actual room temp/outdoor temp switch cooling and heating.
- Auto 3** The actual room temp and outdoor temp switch cooling and heating.

The method of switching between cooling and heating in the auto operation mode can be selected from three options.  
Set the condition for each method.

**23 Thermo. rule setting**

Thermo. rule setting

Standard/Outdoor temp basis **24**

Cooling offset

Heating offset

Select the item. Back

**24 Standard/Outdoor temp basis**

Standard/Outdoor temp basis

Standard

Outdoor temp basis

Select the item. Back

**25 Auto fan speed control**

Auto fan speed control

Auto 1

Auto 2

Select the item. Back

Set the room temperature control, thermostat ON/OFF switching method and condition.

- Standard** The thermostat judges based on the indoor temperature and set temperature.
- Outdoor temp basis** The thermostat judges based on the outdoor temperature and the cooling and heating offset values. The room temperature setting will be disabled.

Set the switching range of the fan tap at the auto fan speed setting.

- Auto 1** The fan tap is changed in the range of High ⇒ Medium ⇒ Low.
- Auto 2** The fan tap is changed in the range of Powerful high ⇒ High ⇒ Medium ⇒ Low.

**26 IU overload alarm**

IU overload alarm

Cancel ▲ ▼ 7 °C Set

Tap ▲ ▼ To set temp & tap [Set]. Back

When the room temperature differs to some extent from the setting temperature at 30 minutes after the start of operation, the overload alarm signal is transmitted from the external output (CNT-5).

# 11 . Service & Maintenance

TOP screen   **Menu**   ⇒   **Service setting**   ⇒   **Service & Maintenance**   ⇒   **Service password**

① Service & Maintenance #1

Service & Maintenance

UI address   <3>

Next service date   <5>

Operation data   <7>

Error display   <9>

Saving IU settings   <14>

Select the item.

Next   Back

The selected screen is displayed.

② Service & Maintenance #2

Service & Maintenance

Special settings   <15>

Indoor unit capacity display   <16>

Select the item.

Previous   Back

The selected screen is displayed.

③ IU address

IU address   Check

| IU address | Name of IU | IU address |
|------------|------------|------------|
| 000        |            |            |
| 001        |            |            |
| 002        |            |            |
| 003        |            |            |
| 004        |            |            |
| 005        |            |            |
| 006        |            |            |

Next   Back

When 8 or more units are connected, further data are displayed on the next page. When the **Check** button is tapped after selecting an IU address, the fan of the selected IU can be operated. ⇒ ④

④ Check run mode

Check run mode

Fan operation   Run   Stop

Tap [Run] to check.   Back

**Run** Tap this button to start the fan operation.  
**Stop** Tap this button to stop the fan operation.

⑤ Next service date

Next service date

Set the date.

No setting   Set   Back

When next service date is entered, messages are displayed at the start/stop of operation on the service month.  
Contents are reset if the next service date is updated.  
If the **No setting** button is tapped, messages are not displayed.

⑥ Service message

Usage time   1 years & 9 months

Next check   10 / 2020

Company   Phone No.

⑦ Operation data

Operation data   Update

| IU                      | 000 | IU      |       |
|-------------------------|-----|---------|-------|
| Item                    |     | Data    | Disp. |
| 01 Operation mode       |     | Cooling | ✓     |
| 02 Set temp             |     | 28°C    | ✓     |
| 03 Return air temp      |     | 28°C    | ✓     |
| 04 R/C temp             |     | 29°C    |       |
| 05 IU heat exch. temp 1 |     | 10°C    |       |

Display   Next   Back

Select 6 items for display & tap [Display].

⑧ Individual display

Operation data

| Operation mode       | Cooling |
|----------------------|---------|
| Set temp             | 28°C    |
| Return air temp      | 29°C    |
| R/C temp             | 28°C    |
| IU heat exch. temp 1 | 10°C    |
| IU heat exch. temp 2 | 15°C    |

Back

Automatically updates and displays the six selected items.

After read the indoor unit data, the operation data at the time of reading are displayed. Tapping the **Update** button to update the data.  
To automatically update data and display, up to six items can be selected. Tapping the **Display** button after selecting six items changes the display to ⑧ .

**⑨ Error display**

**Error display**

Error history <⑩

Display anomaly data <⑪

Erase anomaly data <⑫

Reset periodical check <⑬

Select the item. Back

**⑩ Error history (Sample)**

**Error history** Delete

| Time               | IU  | ErrorCode |
|--------------------|-----|-----------|
| 2011/01/19 6:57 PM | 014 | E 12      |
| 2011/01/19 6:57 PM | 015 | E 15      |
| 2011/01/19 6:57 PM | 012 | E 14      |
|                    |     |           |
|                    |     |           |
|                    |     |           |

Select the item. Back

**⑪ Display anomaly data**

**Display anomaly data**

| IU                       | 000 | ErrorCode | E09 | OU      |
|--------------------------|-----|-----------|-----|---------|
| Item                     |     |           |     | Data    |
| 01) Operation mode       |     |           |     | Cooling |
| 02) Set temp.            |     |           |     | 28°C    |
| 03) Return air temp      |     |           |     | 26°C    |
| 05) IU heat exch. temp 1 |     |           |     | 10°C    |
| 06) IU heat exch. temp 2 |     |           |     | 10°C    |

Select the item. Next Back

Date and time when error occurred, IU address and Error Code are displayed.

Tap the **Delete** button to delete the error history.

The operation data obtained just before the occurrence of an error are displayed.

**⑫ Erase anomaly data**

**Erase anomaly data**

Yes

Select the item. Back

The anomaly data is erased.

**⑬ Reset periodical check**

**Reset periodical check**

Do you want to reset the periodical check?

Yes

If yes, tap [Yes] Back

The time count is reset by resetting the periodical check.

**⑭ Saving IU settings**

**Saving IU settings**

Save IU settings

Automatic saving

Transfer the saved data

Select the item. Back

**Save IU settings** All settings of the IUs connected to the R/C are saved in the R/C.

**Automatic saving** Set the time when the automatic saving is performed everyday.

**Transfer the saved data** The IU setting data saved in the R/C are transferred to an indoor unit.

**⑮ Special settings**

**Special settings**

Erase IU address

CPU reset

Restore of default setting

Touch panel calibration

Select the item. Back

The selected screen is displayed.

**Erase IU address** Memory of the IU address for multi (KX) unit is erased.

**CPU reset** Microcomputers of IU and OU connected are reset (State of restoration after power failure).

**Restore of default setting** Settings on R/C and IU connected are initialized (State of factory default).

**Touch panel calibration** Use this to correct when the display and the touch position are not matched.

**⑯ Indoor unit capacity display**

**Indoor unit capacity display**

| IU address | Capacity |
|------------|----------|
| 000        | 40       |
| 001        | 71       |
| 002        | 80       |
| 003        | 112      |
| 004        | 224      |
| 005        | 280      |

Select the item. Next Back

Capacities of IUs connected to the R/C are displayed.

When seven units or more are connected, tap the **Next** button to view all.

These items may not be displayed depending on the combination of IUs and OUs.

---

# REMOTE CONTROL

## QUICK REFERENCE

### OPERATION

---

Refer to the “User's manual” on the following web site for details.

[http://www.mhi-mth.co.jp/en/products/detail/air-conditioner\\_users\\_manual.html](http://www.mhi-mth.co.jp/en/products/detail/air-conditioner_users_manual.html)



### Contents

---





|   |    |
|---|----|
| ■ 1. Safety precautions .....                             | 22 |
| ■ 2. Functions and menu items of the remote control ..... | 24 |
| ■ 3. Basic Operation .....                                | 27 |
| ■ 4. Menu operations .....                                | 32 |
| ■ 5. Settings and operations .....                        | 33 |
| • Energy-saving setting .....                             | 33 |
| • Individual flap control .....                           | 36 |
| • Anti draft setting .....                                | 38 |
| • Ventilation operation .....                             | 39 |
| • Initial settings .....                                  | 39 |
| • Timer .....   | 41 |
| • Weekly timer .....                                      | 46 |
| • Registering favorite setting .....                      | 48 |
| • Favorite setting operation .....                        | 48 |
| • Silent mode control .....                               | 48 |
| • Select the language .....                               | 49 |
| ■ 6. Maintenance and After-sale service .....             | 50 |
| • Filter sign reset .....                                 | 50 |
| • Maintenance of unit and LCD .....                       | 50 |
| • Contact company & Error display .....                   | 51 |
| • Notice of inspection date .....                         | 51 |
| • After-sale service .....                                | 51 |

# 1. Safety precautions

- Please read the precautions written here carefully to operate the unit properly.  
You are required to observe these fully because every item of these instructions is important for safety.

|   |   |
|---|---|
|  <b>WARNING</b> | Failure to follow these instructions may result in serious consequences such as death, severe injury, etc.    |
|  <b>CAUTION</b> | Failure to follow these instructions may cause injury, property damage or, serious consequences depending on. |

- The following pictograms are used in the text.

|  |                             |   |                                       |
|--|-----------------------------|---|---------------------------------------|
|  | Never do.                   |  | Always follow the instructions given. |
|  | Absolutely keep water away. |  | Absolutely keep wet hands away.       |

- Keep this manual at a safe place where you can consult with whenever necessary. Show this manual to installers when moving or repairing the unit. When the ownership of the unit is transferred, this manual should be given to a new owner.
- **Electrical wiring work must be implemented only by qualified specialists.**

## WARNING



**Consult your dealer or a professional contractor to install the unit.**  
Improper installation made on your own may cause electric shocks, fire or dropping of the unit.



**Consult your dealer when moving, disassembling or repairing the unit.**  
**Never modify the unit.**  
Improper handling may result in injury, electric shocks, fire, etc.



**Avoid using combustible substances (hair spray, insecticide, etc) near the unit.**  
**Do not use benzene or paint thinner to clean the unit.**  
It could cause cracks, electric shocks or fire.



**Stop operation under abnormal situation.**  
If continued, it could result in break-down, electric shocks, fire, etc.  
If any abnormal condition (burnt odor etc.) occurs, stop operation, turn off the power switch and consult your dealer.



**This appliance can be used by children aged from 8 years and above and persons with reduced physical, sensory or mental capabilities or lack of experience and knowledge if they have been given supervision or instruction concerning use of the appliance in a safe way and understand the hazards involved.**

## ⚠ CAUTION



**Do not use or let use the unit or remote control as play equipment.**

Improper operations could cause ill health or health disorder.



**Never disassemble the remote control.**

If you touch internal parts accidentally, you could get electric shocks or cause trouble. Consult your dealer when it is necessary to inspect its interior.



**Do not wash the remote control with water or liquid.**

It could cause electric shocks, fire or break-down.



**Do not touch electric parts or operate buttons or screens with wet hands.**

It could cause electric shocks, fire or break-down.



**Do not dispose the remote control by yourself.**

It could destruct the environment. Ask your dealer when it is necessary to dispose the remote control.

## Note



**The remote control should not be installed where it is exposed to direct sunlight or the ambient temperatures become higher than 40°C or lower than 0°C.**

It could cause deformation, discoloration or break-down.



**Do not use benzene, paint thinner, wipes etc. to clean the remote control.**

It could discolor or break-down the remote control. Wipe it with a piece of cloth which is squeezed tightly after wetting with diluted neutral detergent. Finish up the cleaning by wiping with a piece of dry cloth.



**Do not pull or twist the cable of the remote control.**

It could cause break-down.



**Do not tap the remote control buttons or screen with pointed objects.**

It could damage or cause break-down.

# 2. Functions and menu items of the remote control

## Names and functions of sections on the R/C (Operating section)

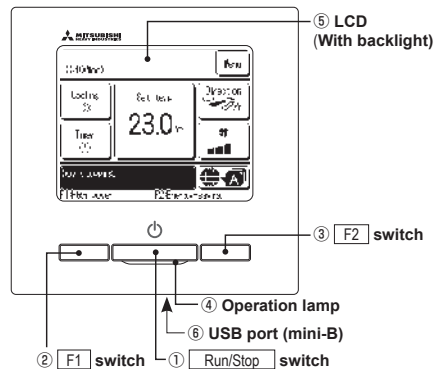

Touch panel system, which is operated by tapping the LCD screen with a finger, is employed for any operations other than the ① Run/Stop, ② F1 ③ F2 switches.

### ① Run/Stop switch

One push on the button starts operation and another push stops operation.

### ② F1 switch ③ F2 switch

This switch starts operation that is set in F1/F2 function setting.

### ④ Operation lamp

This lamp lights in green (yellow-green) during operation. It changes to red (orange) if any error occurs. Operation lamp luminance can be changed.

### ⑤ LCD (With backlight)

A tap on the LCD lights the backlight. The backlight turns off automatically if

there is no operation for certain period of time.

Lighting period of the backlight lighting can be changed.

If the backlight is ON setting, when the screen is tapped while the backlight is turned off, the backlight only is turned on. (Operations with switches ①, ② and ③ are excluded.)

### ⑥ USB port

USB connector (mini-B) allows connecting to a personal computer. For operating methods, refer to the instruction manual attached to the software for personal computer (remote control utility software).

### Note

• When connecting to a personal computer, do not connect simultaneously with other USB devices. Please be sure to connect to the computer directly, without going through a hub, etc.

## Names and functions of sections on the R/C (Display)

\*All icons are shown for the sake of explanation.

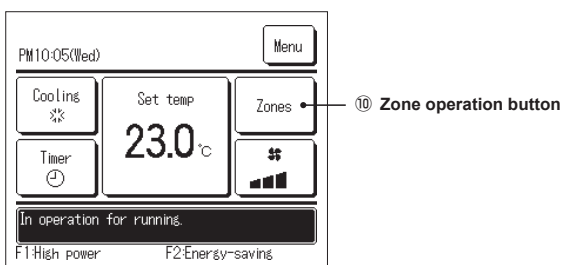
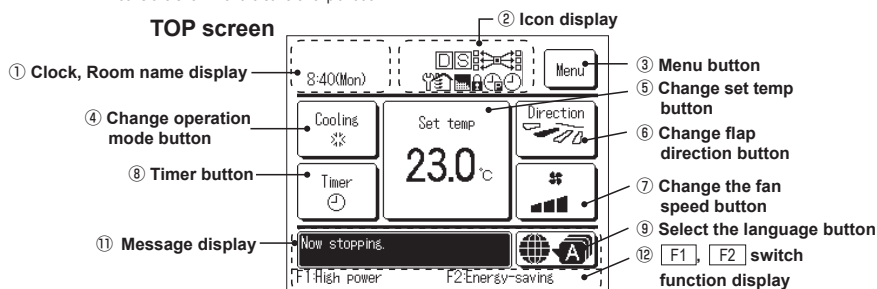

### ① Clock, Room name display

Displays the current time and the room name.

### ② Icon display

Each icon is displayed when one of following settings is going on.

When the demand control is effective.

When the central control (Optional) is running.

During the ventilation operation.

When the Permission/Prohibition setting is made.

When the weekly timer is set.

When setting is made from the sub R/C.

When the periodical inspection is necessary.

When "filter sign" is up.

When the peak-cut timer is set.

### ③ Menu button

When setting or changing other than the following ④-⑧, tap the menu button. Then menu items are displayed, select one and set.

### ④ Change operation mode button

Displays the operation mode which is selected currently. Tap this button to change the operation mode.

### ⑤ Change set temp button

Displays the temperature which is set currently. Tap this button to change the set temperature.

### ⑥ Change flap direction button

Displays the flap direction which is selected currently. When the 3D auto flow operation is enabled, 3D auto display will appear. Tap this button to change the flap direction.

### ⑦ Change the fan speed button

Displays the fan speed which is selected currently. Tap this button to change the fan speed.

### ⑧ Timer button

Displays simplified contents of the timer which is set currently. (When two or more timers are set, contents of the timer which will be operated immediately after is displayed.)

Tap this button to set the timer.

### ⑨ Select the language button

Select a language to be displayed on the R/C.

### ⑩ Zone operation button

Tap this button to go to the zone operation screen.

### ⑪ Message display

Status of air conditioner operation and messages of the R/C operations etc. are displayed.

### ⑫ F1, F2 switch function Display

Displays the function that is set for each F1, F2 switch. The function for these switches can be changed in F1/F2 function setting.

|                              |   |
|------------------------------|---|
| <b>Main menu</b>             |   |
| <b>Basic operation</b>       | <ul style="list-style-type: none"> <li>Run ..... 27</li> <li>Stop ..... 27</li> <li>Change operation mode ..... 27</li> <li>Change set temp ..... 27</li> <li>Change flap direction ..... 28</li> <li>Change the fan speed ..... 29</li> <li>Zone ON/OFF operation ..... 29</li> <li>Zone name setting ..... 29</li> <li>F1, F2 switch operation ..... 30</li> <li>Anti draft ON/OFF operation ..... 30</li> <li>High power operation ..... 31</li> <li>Energy-saving operation ..... 31</li> </ul>   |
| <b>Useful functions</b>      | <ul style="list-style-type: none"> <li>Individual flap control ..... 36</li> <li>Anti draft setting ..... 38</li> <li>Timer ..... 41 <ul style="list-style-type: none"> <li>Set ON timer by hour ..... 42</li> <li>Set OFF timer by hour ..... 43</li> <li>Set ON timer by clock ..... 43</li> <li>Set OFF timer by clock ..... 45</li> <li>Confirm ..... 45</li> </ul> </li> <li>Favorite setting operation ..... 48</li> <li>Weekly timer ..... 46</li> <li>Home leave mode ..... Refer to user's manual</li> <li>Ventilation operation ..... 39</li> <li>Select the language ..... 49</li> <li>Silent mode control ..... 48</li> </ul>   |
| <b>Energy-saving setting</b> | <ul style="list-style-type: none"> <li>Sleep timer ..... 33</li> <li>Peak-cut timer ..... 34</li> <li>Automatic temp set back ..... 35</li> <li>Motion sensor control ..... 35</li> </ul>   |
| <b>Filter</b>                | <ul style="list-style-type: none"> <li>Filter sign reset ..... 50</li> </ul>  |
| <b>User setting</b>          | <ul style="list-style-type: none"> <li>Initial settings ..... 39 <ul style="list-style-type: none"> <li>Clock setting ..... 39</li> <li>Date &amp; time display ..... 40</li> <li>Summer time ..... 40</li> <li>Contrast ..... 40</li> <li>Backlight ..... 40</li> <li>Controller sound ..... 41</li> <li>Operation lamp luminance ..... 41</li> </ul> </li> <li>Administrator settings ..... Refer to user's manual <ul style="list-style-type: none"> <li>Permission/Prohibition setting ..... Refer to user's manual</li> <li>Outdoor unit silent mode timer ..... Refer to user's manual</li> <li>Setting temp range ..... Refer to user's manual</li> <li>Temp increment setting ..... Refer to user's manual</li> <li>Set temp display ..... Refer to user's manual</li> <li>R/C display setting ..... Refer to user's manual</li> <li>Change administrator password ..... Refer to user's manual</li> <li>F1/F2 function setting ..... Refer to user's manual</li> </ul> </li> </ul> |
| <b>Service setting</b>       | Refer to Installation manual  |
| <b>Contact company</b>       | 51  |

# 3. Basic Operation

## Run

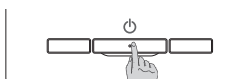

Push the **Run/Stop** switch.  
Operation lamp (green) lights and operation starts.

## Stop

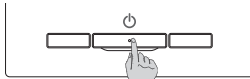

Press the **Run/Stop** switch while the unit is in operation.  
The operation lamp turns off and the operation stops.

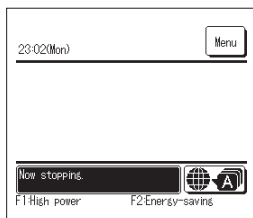

When the operation stops, all operation buttons on the screen turn off. When the set lighting time of backlight is counted up, the backlight turns off.

When the screen is tapped, the backlight lights, and all operation buttons are displayed.

### Note

- Do not shut down the power supply immediately after the stop of operation. It should be waited for more than 5 minutes till the residual operation time of drain motor is counted up. Otherwise, it could cause water leakage or breakdown.

### Advice

- A message "Invalid request" may be displayed when a button is pushed. This is not a fault but it is because the button operation is set to the "Disable".
- The unit starts to operate initially with the following settings after the power on. These settings can be changed as desired.
 

|                 |  |
|-----------------|--|
| Central control | ..... OFF  |
| Operation mode  | ..... With auto mode: Auto cooling                       |
|                 | ..... Without auto mode: Cooling                         |
| Set temp        | ..... 23.0°C   |
| Fan speed       | ..... 3-speed  |
| Flap direction  | ..... When cooling: position 2, when heating: position 3 |

\*When an FDK with a left/right flap is connected, left/right flap direction: center, 3D AUTO: disabled
- In the following cases, a message "Operation mode is invalid" is displayed and it changes to the fan operation, because operation modes are not matched.
  - When Heating (including auto heating) is selected for Operation mode while using an OU for cooling only.
  - When Heating is selected for Operation mode while controlling multiple units including units allowed for both cooling and heating and units for cooling only.
  - When different operation modes are selected between IUs which are connected to a OU that do not allow mixed operation of cooling and heating.

## Change operation mode

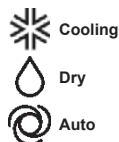
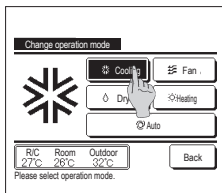
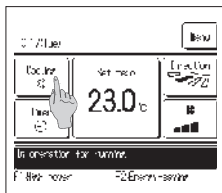

1 Tap the **Change operation mode** button on the TOP screen.

2 When the Change operation mode screen is displayed, tap the button of desired mode.  
The operation mode changes, and the display returns to the TOP screen.  
Icons displayed have the following meanings.

- Operation modes which cannot be selected depending on combinations of IU and OU are not displayed.
- When the Auto is selected, the cooling and heating switching operation is performed automatically according to indoor and outdoor temperatures.

## Change set temp



1 Tap the **Change set temp** button on the TOP screen.

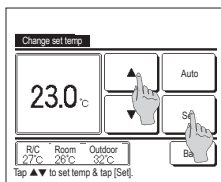

2 When the Change set temp screen is displayed, select the temperature as desired with using **▲** **▼** buttons.  
3 After selecting the set temp, tap the **Set** button. The display returns to the TOP screen.

■ For allowable temperature setting ranges, refer to the range setting of set temp.

■ Reference set temp

Cooling ... 26 to 28°C Dry ... 24 to 26°C Heating ... 20 to 24°C Fan ... Setting temp is not required.

■ If the [Auto] is selected for the set temp, the set temp display shows "0". Temperature can be adjusted higher or lower with using [▲] [▼] buttons. Note that [Auto] is not displayed and cannot be set when SC-SL2, SC-SL3, or SC-SL4 is connected.

■ If the [Back] button is tapped without tapping the [Set] button, the selected set temp is invalidated and the display returns to the TOP screen.

## Change flap direction

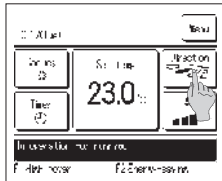

1 Tap the [Change flap direction] button on the TOP screen.

When an FDK with a left/right flap is not connected: (≡ 2)

When one or more FDKs with a left/right flap are connected: (≡ 3)

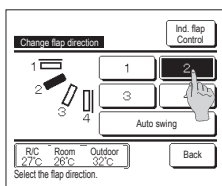

2 When the Change flap direction screen is displayed, tap the button of desired flap direction.

To swing the flap, tap the [Auto swing] button.

To fix the flap position, tap one of [1] to [4] buttons.

After selecting the flap direction,

When an FDK with a left/right flap is not connected, the display returns to the TOP screen. (≡ 1)

When an FDK with a left/right flap is connected, the display returns to the Select flap screen. (≡ 3)

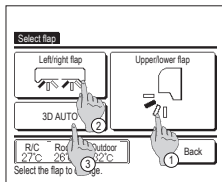

3 When one or more FDKs with a left/right flap are connected, the Select flap screen is displayed. Select the desired flap direction.

① To change the up/down flap direction, tap the [Upper/lower flap] button. The Change flap direction screen for the up/down flap is displayed. (≡ 2)

② To change the left/right flap direction, tap the [Left/right flap] button. The Change flap direction screen for the left/right flap is displayed. (≡ 4)

③ The 3D auto flow operation automatically controls the fan speed and flap direction to efficiently condition the air of the entire room.

To switch to the 3D auto flow operation, tap [3D AUTO] to enable the operation.

To disable the 3D auto flow operation, tap the [3D AUTO] again. The flap direction returns to the direction that was set before the 3D auto flow operation was enabled. The 3D auto flow operation will also be disabled when you change the up/down or left/right flap direction during the 3D auto flow operation.

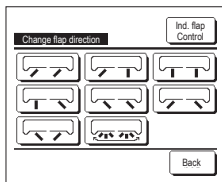

4 Tap the desired flap direction. After selecting the flap direction, the display returns to the Select flap screen. (≡ 1)

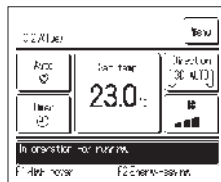

5 When the 3D auto flow operation is enabled, "3D AUTO" is displayed on the [Change flap direction] button, as shown on the left.

■ When multiple IUs are connected to the remote control for a mixed environment consisting of FDKs with a left/right flap and IUs without a left/right flap, enabling the 3D auto flow operation will set the models without a left/right flap to a flap position set before the 3D auto flow operation was started.

■ Since the flap is controlled automatically in the following operation, it may differ from the display on the R/C.

- When the room temperature is higher than the set temp (In case of the heating operation)
- When the "In operation for heating standby," or "In operation for defrosting," is displayed (In case of the heating operation).  
Cool air is blown horizontally not to blow directly to human body.
- In a high humidity environment (during cooling operation)

■ When you select Auto swing while the Anti draft setting is enabled, the flap will not swing and be set at flap position [1].

■ Changing the left/right flap direction and 3D auto flow operation cannot be performed from the SC-SL2, SC-SL3, or SC-SL4. Also note that 3D auto flow operation will not be disabled when you change the flap direction from the SC-SL2, SC-SL3, or SC-SL4 during a 3D auto flow operation.

### Note

- Do not manually move the flaps or panel with anti draft by force. It could damage these flaps and panels.
- Do not blow air downward for a long period of time during the cooling operation. Condensation may be generated and water may drip from the side panel. (In case of Ceiling suspended type)
- For FDKs with a left/right flap, it is recommended that the flap should be set toward the right side when there is a wall on the left, or set toward the left side when there is a wall on the right. For more information, refer to the Notes in the Individual flap control section.

## Change the fan speed

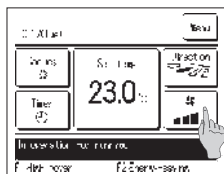

- 1 Tap the **Change the fan speed** button on the TOP screen.

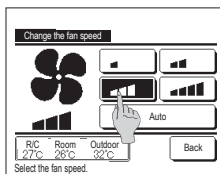

- 2 When the Change the fan speed screen is displayed, tap the button of desired fan speed.  
After setting the fan speed, the display returns to the TOP screen.

■ Fan speeds which can be set vary depending on the models of IU.

■ When the **Auto** is selected, the fan speed is changed automatically depending on the capacity.

Note that **Auto** is not displayed and cannot be set when SC-SL2 or SC-SL3 is connected.

## Zone ON/OFF operation (for zone control)

The "Zones" button appears on the TOP screen when zone settings were performed by **Menu** ⇒ **Service setting** ⇒ **Installation setting** ⇒ **Duct unit setting** ⇒ **Zone setting**.

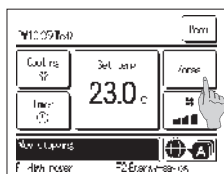

Tap the **Zones** button.

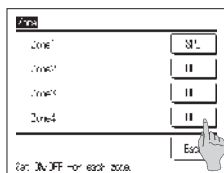

Sets **ON** / **OFF** (OPEN/CLOSE) for each zone.



\*1: If there is no common zone, the spill zone is OFF, and one or more other zone is OFF, the spill zone will open automatically and **SPL** will be displayed.

### Advice

Common zone: A zone in which a damper is not installed.  
Spill zone: A zone in which a damper open automatically.

## Zone name setting (for zone control)

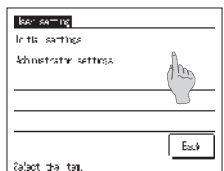

- 1 Tap the **Menu** button on the TOP screen and select **User setting** ⇒ **Administrator settings**.

The administrator password input screen is displayed.

Enter the administrator password.

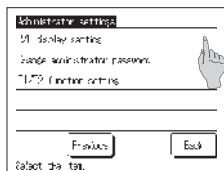

- 2 When the administrator setting menu is displayed, select **R/C display setting** ⇒ **Zone name**.

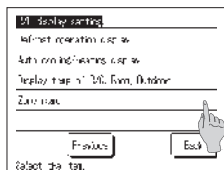

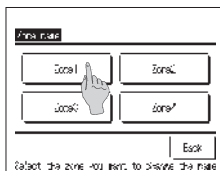

3 Tap the zone you want to set a zone name for.



4 The zone name input screen is displayed.

The zone name can be set with up to 8 2-byte letters (16 1-byte letters).

You can enter alphanumeric or Cyrillic.

Tap the **Back** or **Next** button to display next character group.

When you have finished inputting the room name, tap **Set**.

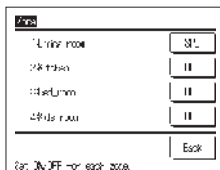

5 The zone name that was set is displayed on the zone operation screen.

## F1/F2 switch operation

You can set any of the following functions to the **F1** and **F2** switches.

The **F1** / **F2** switches act as shortcuts; it can be much easier and faster than starting an operation from the usual **Menu** on the TOP screen.

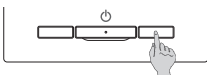
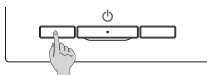

Changing the function of the **F1** or **F2** switch can be performed with the F1/F2 function setting. The following functions are set as factory settings.

You may change these settings as desired.

- |                        |                              |                       |
|------------------------|------------------------------|-----------------------|
| <b>F1</b> switch       | ···High power operation      |                       |
| <b>F2</b> switch       | ···Energy-saving operation   |                       |
| · High power operation | · Energy-saving operation    | · Silent mode control |
| · Home leave mode      | · Favorite setting operation | · Filter sign reset   |
| · Anti draft ON/OFF    |                              |                       |

### Advice

· When using a standard FDT/FTDC panel (a panel without anti draft function), set functions other than the Anti draft ON/OFF function to the **F1** and **F2** switches. F1/F2 function setting (\*\*Refer to user's manual.)

If anti draft is turned on (operated) during the use of a standard FDT/FTDC panel, louvers may not automatically swing, which is not a malfunction.

## Anti draft ON/OFF operation (for using panel with anti draft)

Anti draft can be turned ON/OFF (operated/stopped) with a single tap of the button.

To turn ON/OFF the anti draft with the **F1** or **F2** switch, the anti draft ON/OFF function needs to be preset to the **F1** or **F2** switch. (\*\*Refer to user's manual.)

Initially, Anti draft ON/OFF or high power operation is set to the **F1** switch. (It is automatically determined according to the connected indoor unit.)

■ When the sub R/C is set, Anti draft ON/OFF setting cannot be used.



1 Push the **F1** ( **F2** ) switch. Anti draft is turned ON (operated).

"Anti draft ON" is displayed in the **F1** ( **F2** ) switch function display area.

■ The enabled operation mode and the enabled anti draft of the blow outlets operate based on the details set in the Anti draft setting.

■ If anti draft is turned on (operated) during the use of the standard FDT, FTDC panel, louvers may not automatically swing, which is not a malfunction.

■ While the unit is stopped, anti draft does not operate even when "Anti draft ON" is displayed. Anti draft will operate when you press the **Run/Stop** switch to start the unit operation.

■ If no indoor unit equipped with anti draft function is connected, a message "Invalid request." is displayed on the R/C screen.

■ Depending on how the Permission/Prohibition setting (\*\*Refer to user's manual.) is set, the administrator password input screen may be displayed.

2 Press the **F1** ( **F2** ) switch. Anti draft is turned OFF (stopped).

"Anti draft OFF" is displayed in the **F1** ( **F2** ) switch function display area.

3 When two or more indoor units equipped with anti draft function are connected to the R/C, the indoor unit No. and the ON/OFF state of each anti draft are displayed by pressing the **F1** ( **F2** ) switch. Set ON or OFF for each indoor unit.

Anti draft is turned OFF by tapping ON and turned ON by tapping OFF.

All of the connected indoor units that are equipped with anti draft function are turned ON by pressing the **All ON** button.

All of the connected indoor units that are equipped with anti draft function are turned OFF by pressing the **All OFF** button.

In the **F1** ( **F2** ) switch function display area, the anti draft ON/OFF state of the indoor unit that has the smallest address among the indoor units equipped with anti draft function is displayed.

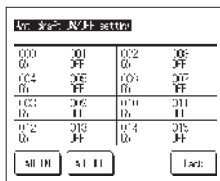

## High power operation

The high power operation adjusts the room temperature quickly to a pleasant level by increasing the operation capacity.

The high power operation continues for 15 minutes at the maximum and returns to the normal operation automatically. When the operation mode is changed, the high power operation returns to the normal operation, too.

High power operation must be set to the **[F1]** or **[F2]** switch.

High power operation is set to the **[F1]** switch as the factory setting.

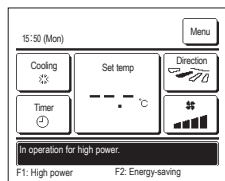

### 1 Push the **[F1]** (**[F2]**) switch to start the high power operation.

■ Operation will start when the **[F1]** (**[F2]**) switch is pushed, even if **[Run/Stop]** switch is off.

■ High power operation is only allowed when Heating or Cooling is selected for the operation mode.

Message "In operation for high power." is displayed on the R/C screen, and "—, —°C" is displayed on the Set temp button during the high power operation.

■ Set temp and change fan speed operations are disabled during high power operation.

### 2 High power operation is terminated when you perform one of the following.

- When you terminate through a **[Run/Stop]** operation
- When you change the operation mode
- When 15 minutes have elapsed since the high power operation started
- When you terminate the high power operation with the **[F1]** (**[F2]**) switch

## Energy-saving operation

Use this operation to save energy. Set temp is fixed at 28°C in the cooling operation or 22°C in the heating operation. Since the capacity is controlled automatically based on the outdoor temperature, energy can be saved without losing comfort.

Energy-saving operation must be set to the **[F1]** or **[F2]** switch.

Energy-saving operation is set to the **[F2]** switch as the factory setting.

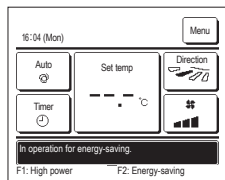

### 1 Push the **[F1]** (**[F2]**) switch to start the energy-saving operation.

■ Operation will start even if you press the **[F1]** (**[F2]**) switch while the unit is stopped.

■ Energy-saving operation is only allowed when Heating, Cooling or Auto is selected for the operation mode.

Message "In operation for energy-saving." is displayed on the screen during the energy-saving operation. Set temp is fixed at "28.0°C" in the cooling operation or "22.0°C" in the heating operation. Set temp shows "—, —°C" in the automatic operation mode.

■ Set temp cannot be changed during the energy-saving operation. If it is attempted, a message "Invalid request" is displayed on the screen.

### 2 Energy-saving operation is terminated when you perform the following.

- When you terminate through a **[Run/Stop]** operation
- When you change the operation mode
- When you terminate the energy-saving operation with the **[F1]** (**[F2]**) switch

# 4. Menu operations

## Restrictions on the sub R/C

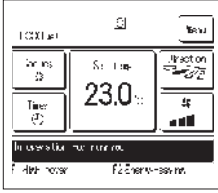

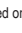
When one IU is controlled with 2 R/Cs, the following settings cannot be made on the sub R/C. It is necessary to use the main R/C.  
In case of the sub R/C, the icon  is displayed on the R/C screen.

| R/C operations  |                                | Main                  | Sub                              |
|---|--------------------------------|-----------------------|----------------------------------|
| Run/Stop, Change set temp, Change flap direction, Auto swing, Change fan speed operations |                                | <input type="radio"/> | <input type="radio"/>            |
| Anti draft  |                                | <input type="radio"/> | <input checked="" type="radio"/> |
| High power operation, Energy-saving operation   |                                | <input type="radio"/> | <input type="radio"/>            |
| Silent mode control   |                                | <input type="radio"/> | <input checked="" type="radio"/> |
| Useful functions  | Individual flap control        | <input type="radio"/> | <input checked="" type="radio"/> |
|   | Anti draft setting             | <input type="radio"/> | <input checked="" type="radio"/> |
|   | Timer                          | <input type="radio"/> | <input type="radio"/>            |
|   | Favorite setting               | <input type="radio"/> | <input type="radio"/>            |
|   | Weekly timer                   | <input type="radio"/> | <input checked="" type="radio"/> |
|   | Home leave mode                | <input type="radio"/> | <input checked="" type="radio"/> |
|   | External ventilation           | <input type="radio"/> | <input type="radio"/>            |
|   | Select the language            | <input type="radio"/> | <input type="radio"/>            |
|   | Silent mode control            | <input type="radio"/> | <input checked="" type="radio"/> |
| Energy-saving setting   |                                | <input type="radio"/> | <input checked="" type="radio"/> |
| Filter  | Filter sign reset              | <input type="radio"/> | <input type="radio"/>            |
| User setting  | Initial settings               | <input type="radio"/> | <input type="radio"/>            |
|   | Administrator settings         | <input type="radio"/> | <input checked="" type="radio"/> |
|   | Permission/Prohibition setting | <input type="radio"/> | <input checked="" type="radio"/> |
|   | Outdoor unit silent mode timer | <input type="radio"/> | <input checked="" type="radio"/> |
|   | Setting temp range             | <input type="radio"/> | <input checked="" type="radio"/> |
|   | Temp increment setting         | <input type="radio"/> | <input checked="" type="radio"/> |
|   | Set temp display               | <input type="radio"/> | <input type="radio"/>            |
|   | R/C display setting            | <input type="radio"/> | <input type="radio"/>            |
|   | Change administrator password  | <input type="radio"/> | <input type="radio"/>            |
|   | F1/F2 function setting         | <input type="radio"/> | <input type="radio"/>            |



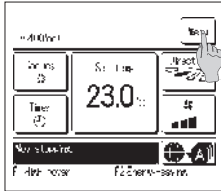

## Operations on menu screens



- 1 Tap the  button on the TOP screen.

Main menu screen is displayed.

When a desired menu item is tapped, setting screen for each item is displayed.

When there are two or more pages, the  button is displayed at the leading page and the  button is displayed at the last page. The  and  buttons are displayed on pages in between.

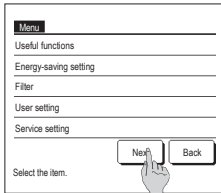

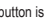

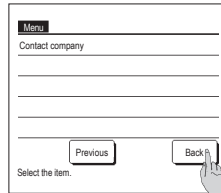
- 2 When the  button is tapped, next main menu screen is displayed.

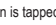

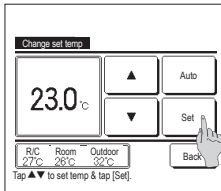
- 3 When the  button is tapped, the display returns to the TOP screen.

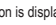

- 4 When the  button is displayed on the setting screen for each item, tapping this button confirms the setting.

■ If you tap  without tapping the  button, the settings made will not be applied, and the display returns to the original screen.

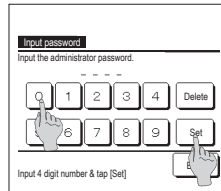

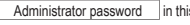
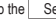
- 5 When an item is referenced to  in this manual, the Input password screen is displayed after selecting the menu.  
Enter the administrator password (4-digit number) and tap the  button.  
When the password is unknown or wrong, the setting cannot be changed.

### Advice

- The administrator password is provided so that these operations and settings are restricted to administrators/managers only (such as the owner of the building).
- For the administrator password at the factory setting, refer to the Installation Manual.
- When your administrator password is forgotten, initialize the password by referring to the Installation Manual.

## Cautions for each setting screen

When returning to the screen mentioned below from each setting screen, operate the following buttons or switches.

- Return to Main screen ...  button
- Return to the last previous screen ...  button
- Return to TOP screen ...  switch

When the  button is tapped without tapping the  button on the way of setting, contents of the setting are invalidated, and the display returns to the last previous screen. If the  switch is pushed on the way of setting, contents of the setting are invalidated, the setting mode is terminated and the display returns to the TOP screen.

If no button is operated for approx. 5 minutes on the way of setting each item, the display returns to the TOP screen automatically. Contents of the setting on the way become invalid.

Message "Invalid request" may be displayed when a button is pushed. This is not a fault but it is because the button is set to the Prohibition.

It is necessary to stop the air conditioner by pushing the  switch before starting the following settings.

If the Set button is tapped on the menu screen while the air conditioner is operating, the message "Invalid request." is displayed.

- Individual flap control    ■ Anti draft setting    ■ Select the language
- Energy-saving setting    ■ Administrator settings

## 5. Settings and operations

### Energy-saving setting [Administrator password]

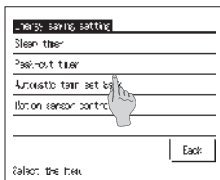

1 Tap the  button on the TOP screen and select . The Energy-saving setting menu screen is displayed.

2 When the Energy-saving setting screen is displayed, select a desired item.

- Sleep timer
- Peak-cut timer
- Automatic temp set back
- Motion sensor control

#### ■ Sleep timer

Stops operation when the amount of time set has elapsed since the start of each operation.

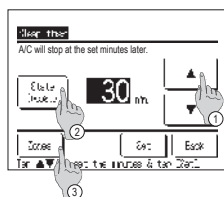

1 Tap the  button on the TOP screen and select  ⇒ . The Sleep timer screen is displayed.

2 Select a desired time with ①   buttons. Setting range: 30 to 240 minutes, at 10-min intervals.

3 Tap the ②  button to switch between "State Enable" and "State Disable".

- "Enable": operation stops at the set time every time.
  - "Disable": the sleep timer does not operate.
- Unless the Sleep timer is used, set at the "State Disable".

4 The ③  button is displayed when performing zone settings. Tapping the ③  button makes it possible to perform zone operation settings at the time of timer working. (The  button is not displayed when not performing zone settings. Proceed to step 6.)

5 Tapping the  button will transition to the zone operation setting screen. Set ④  /  /  (No setting/OPEN/CLOSE) for each zone during timer operation.

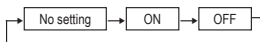

Setting  will operate in the previous zone state at the time of timer working.

After the setting, tap the ⑤  button.

The display returns to the previous screen.

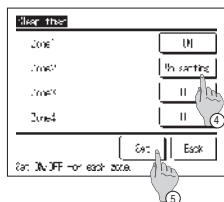



Set the times to start and stop the capacity (upper limit) limiting operation and the peak-cut %.

When the peak-cut timer is used, be sure to make the Clock setting in advance.  
The peak-cut timer control may not be performed depending on combination of IU and OU.



- ① Weekdays : Monday - Friday  
② Sat. Sun : Saturday, Sunday  
③ All days : Monday - Sunday  
④ Each day : Moves to the day of the week setting screen.

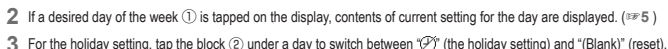

Timer does not operate on the day set as holiday.

Two or more holidays can be set.

■ To enable the timer on the day set as holiday, it is necessary to reset the holiday setting.

- 4 When tapping ③ "All Disable" button, the timer does not operate on all days of the week.

When the timer is used, be sure not to set "All Disable".

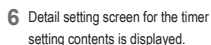
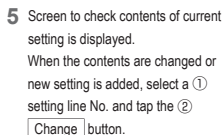

- ① Tap the **State** button to switch between "State Enable" and "State Disable".

- ② If the **Change** button is tapped, the start time and the end time can be set. (P. 7)

- ③ If the **Peak-cut** button is tapped, the peak-cut % can be set. (P.9)

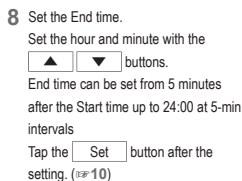
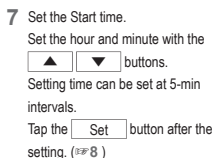

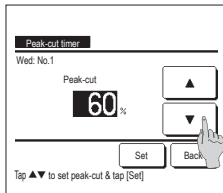

- 9 Set the peak-cut %.
- Set the peak-cut % with the buttons.
- The peak-cut % can be set at 0%, 40%, 60% or 80%.
- The lower the peak-cut % is, the higher the effect of energy-saving becomes.**
- Tap the button after the setting. (≠#10)

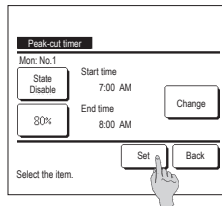

- 10 The setting content check screen (≠#6) is displayed. If the button is tapped, the contents are confirmed and a day of the week setting content check screen (≠#5) is displayed.

- 11 If the settings are corrected or added further within the same day, repeat the setting. (≠#5)

■ When contents of the setting are duplicated, the priority is given to the set contents of smaller peak-cut %.

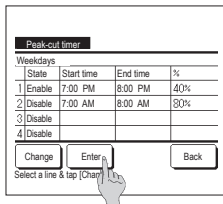

- 12 Display a day of the week setting content check screen. To save the setting, tap the button.

- a) In case of group setting: (1-① Weekdays, 1-② Sat, Sun, 1-③ All days) Move to the group setting check screen. (≠#13)
- b) In case of individual setting: (1-④ Each day) Save the setting and move to a day of the week selection screen (≠#2)

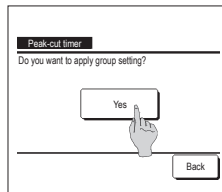

- 13 Display the group setting acknowledge screen.
- Tap the button to save the setting.
- The display changes to a day of the week setting check screen after the saving. (≠#2)

- 14 When making the setting after changing a day of the week, repeat the setting from the step 2.

## Automatic temp set back

It returns to the set temperature when the set time is counted up.

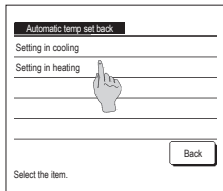

- 1 Tap the button on the TOP screen and select ⇒ . The Automatic temp set back screen is displayed.
- Tap when setting for the cooling operation or when setting for the heating operation.
- The Setting in cooling operation includes the cooling, dry and auto.
- The Setting in heating is for the heating operation only.
- Setting time range: 20 - 120 min, at 10-min intervals
- Set temp range: It can be set within the preset temp range set according to the set temp range menu.

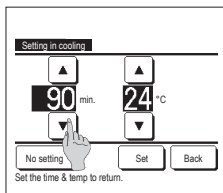

- 2 Set desired time and temperature with the buttons.
- When the button is tapped, contents of setting are confirmed, and the display returns to the last previous screen.
- When the button is tapped, "— min. — °C" is displayed, and the "Automatic temp set back" is not performed.

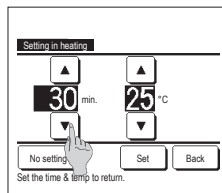

- 3 The same setting method as the Setting in the cooling operation can be applied to the Setting in heating.

## Motion sensor control (for IUs with motion sensors)

Presence of humans and the amount of motion are detected by a motion sensor to perform various controls.

■ When the R/C is set as the sub R/C, the motion sensor control cannot be set.

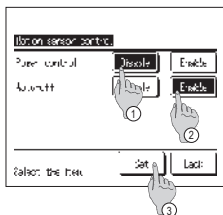

- 1 Tap the button on the TOP screen and select ⇒ . The Motion sensor control screen and contents of the current settings are displayed.
- ① Enable/disable power control.
- ② Enable/disable auto-off.
- ③ After you set each item, tap the button.
- The display returns to the Energy-saving setting menu screen.

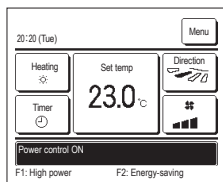

- When power control is enabled

The amount of human motion is detected by a motion sensor to adjust the Set temp.

During power control, "Power control ON" will be displayed on the message display.

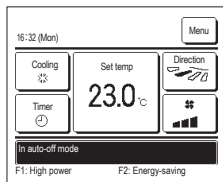

- When auto-off is enabled

The unit will enter the "Operation wait" state when an hour has elapsed since the last time a human presence was detected and will be in "Complete stop" state after another 12 hours.

"Operation wait"...The unit stops but will resume operation when human presence is detected.

When the unit is in "Complete stop", "In auto-off mode" will be displayed on the message display.

"Complete stop"...When auto-off is enabled, the unit stops.

The unit will not resume operation even when human presence is detected.

The message "In auto-off mode" will disappear from the message display, and the operation lamp will turn off.

## Individual flap control

Motion range (upper, lower, left, or right limit positions) of the flap at each blow outlet can be set to a desired range.

- When the R/C is set as the sub R/C, the individual flap control cannot be set.

- 1 Tap the **Menu** button on the TOP screen and select **Useful functions** ⇒ **Individual flap control**, or tap the **Change flap direction** button on the TOP screen and select **Ind. flap control**, and then enter the administrator password.

When one IU is connected to the R/C: **2**

When two or more IUs are connected to the R/C: **2**

### Advice

- Individual flap control should be set when the unit is stopped.
- When you perform Individual flap control while the unit is in operation, the acknowledge screen for unit stop is displayed.

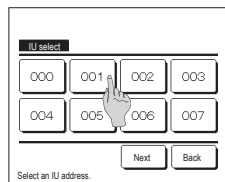

- 2 When two or more IUs are connected to the R/C, a list of IUs is displayed. Tap the IU to be set.

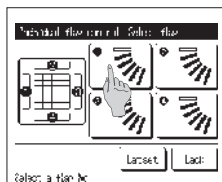

- 3 Select the number of the flap of which the motion range is changed. (**2**)

- When you perform Individual flap control while the unit is stopped and there are two or more flaps at the blow outlet, such as the FDT type, the flap at blow outlet No. ① will keep moving while the blow outlet selection screen is displayed. The figure displayed on the screen shows the installed unit viewed from the floor side. Select the flap based on this figure. When you have selected the blow outlet, the flap with the number you selected will move.

### Advice

- This operation is not performed when individual flap control is set during operation.

- You can set all flaps at once by tapping the **But.set.** button (except for FDKs with a left/right flap).
- When there is only one flap at the blow outlet, such as the ceiling suspended type only the flap that can be set will be displayed.

For an FDK with a left/right flap, select the upper/lower flap or left/right flap.

When you select the upper/lower flap (①): **4**

When you select the left/right flap (②): **8**

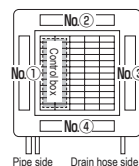
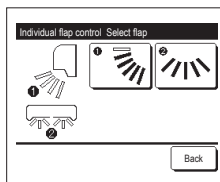

**Louver No.**  
**[For FDT]**

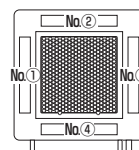

**Louver No.**  
**[For FDT C]**

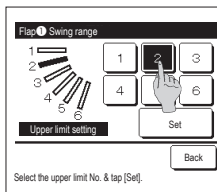

- 4 Select one of the upper limit positions from **1** to **6** for the flap motion range.  
After you select the range, tap the **Set** button.

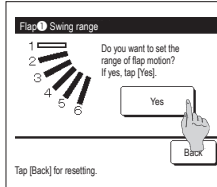

[When left/right flap is selected for an FDK with a left/right flap]

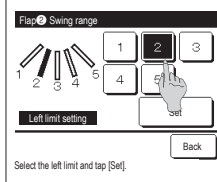

- 8 Select one of the left limit positions from **1** to **5** for the flap motion range.  
After you select the range, tap the **Set** button.

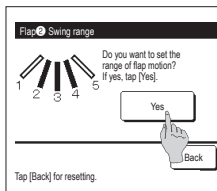

- 10 Acknowledge screen for the flap motion range is displayed.

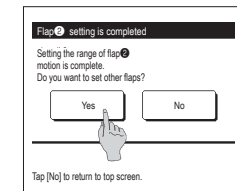

- 11 Acknowledge screen for the completion of setting is displayed.  
To change other flap motion ranges, tap the **Yes** button. (\*≠3)  
To terminate the setting, tap the **No** button. The display returns to the TOP screen.

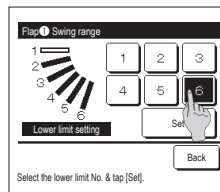

- 5 Select one of the lower limit positions from **1** to **6** for the flap motion range.  
The range of motion between the upper and lower limit positions will be displayed in black.  
After you select the range, tap the **Set** button.

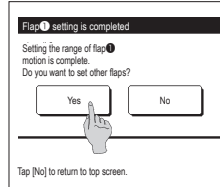

- 7 Acknowledge screen for the completion of setting is displayed.  
To change other flap motion ranges, tap the **Yes** button (\*≠3).  
To terminate the setting, tap the **No** button. The display returns to the TOP screen.

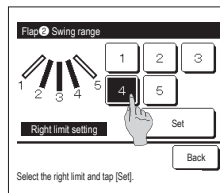

- 9 Select one of the right limit positions from **1** to **5** for the flap motion range.  
The range of motion between the left and right limit positions will be displayed in black.  
After you select the range, tap the **Set** button.

#### Advice

When the unit is installed within 50 cm from a wall, it is recommended that you change the range of the left/right flap motion as follows:

- When installed at the right end of the wall  
Left/right flap motion range **1** to **4**
- When installed at the left end of the wall  
Left/right flap motion range **2** to **5**

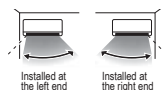

## Anti draft setting (for using panel with anti draft)

You can set ON/OFF (operation/stop) of the anti draft function and can also enable/disable the motion of panel with anti draft for each blow outlet for each operation mode.

■ When the R/C is set as the sub R/C, the anti draft setting cannot be set.

- 1 Tap the **Menu** button on the TOP screen and select **Useful functions** ⇒ **Anti draft setting**.

The Anti draft setting menu is displayed.

■ Depending on how the Permission/Prohibition setting (≠ Refer to user's manual.) is set, the administrator password input screen may be displayed.

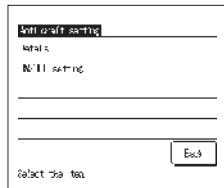

- 2 Tap a desired item.

① Details..... You can set Enable or Disable for anti draft motion performed at each blow outlet in each operation mode. (≠ 34)

② ON/OFF setting..... You can set ON/OFF (operation/stop) of anti draft function for the enabled blow outlet set in ① Details. (≠ 34)

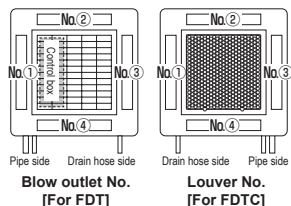

### Details

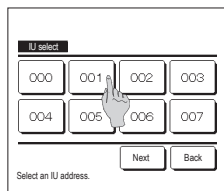

- 1 When two or more IUs are connected to the R/C, a list of IUs is displayed. Tap the IU to be set.

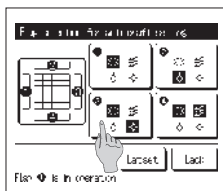

- 2 Select the blow outlet number to set anti draft.

■ The flap at blow outlet No. ① will keep moving while the blow outlet selection screen is displayed. Select the flap based on this figure. When you have selected the blow outlet, the flap with the number you selected will move. The figure displayed on the screen shows the installed unit viewed from the floor side.

■ You can set all blow outlets at once by tapping the **Rest set** button.

An icon that indicates the operation mode is shown on each blow outlet button.

When the anti draft setting is enabled, the icon color will be reversed (for example,

in the left figure, blow outlets which have the anti draft setting enabled during cooling are numbers ①, ③, and ④).

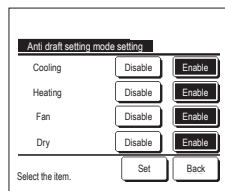

- 3 Select enable/disable for each operation mode.  
After you make the selection, tap the **Set** button.  
The display returns to the blow outlet selection screen.

### ON/OFF setting

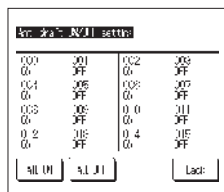

- 1 The indoor unit No. and the ON/OFF state of each anti draft function are displayed to allow ON/OFF setting of the anti draft. Anti draft is turned OFF by tapping ON and turned ON by tapping OFF.

When two or more indoor units equipped with anti draft function are connected to the R/C, the two or more indoor units are displayed.

All of the connected indoor units that are equipped with anti draft function are turned OFF by pressing the **All OFF** button.

All of the connected indoor units that are equipped with anti draft function are turned ON by pressing the **All ON** button.

## Ventilation operation (when ventilation device is installed)

The ventilation is turned on or off if the ventilation device is installed.

- 1 Tap the **Menu** button on the TOP screen and select **Useful functions** ⇒ **External ventilation**.

- The ventilation operation is enabled in case that the External ventilation is set "Independent" (refer to the installation manual for details).
- In case that the External ventilation is set "Disable" or "Interlocking" the ventilation operation is disable.

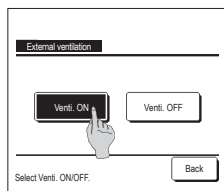

- 2 The External ventilation screen is displayed.

If the **Ventil. ON** button is tapped, the ventilation operation starts.

To stop the ventilation operation, tap the **Ventil. OFF** button.

- In case that the Ventilation is set "Interlocking", the ventilation operates interlocked with Run/Stop operation of air conditioner (refer to Installation Manual).

## Initial settings

- 1 Tap the **Menu** button on the TOP screen and select **User setting** ⇒ **Initial settings**.

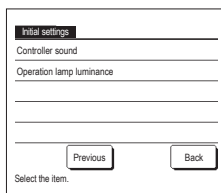
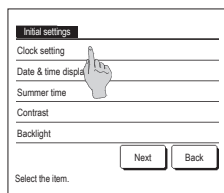

- 2 When the "Initial settings" menu screen is displayed, tap a desired item.

- Clock setting
- Date & time display
- Summer time
- Contrast
- Backlight
- Controller sound
- Operation lamp luminance

### ■ Clock setting

You can set and correct the current date and time.

- 1 Tap the **Menu** button on the TOP screen and select **User setting** ⇒ **Initial settings** ⇒ **Clock setting**.

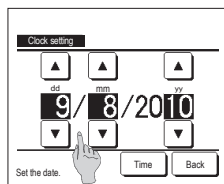

- 2 The "Clock setting" screen is displayed.

Set the "dd/mm/yy" with the **▲** **▼** buttons.

Tap the **Time** button after the setting.

- The "clock setting" is necessary for the following settings.
  - Peak-cut timer
  - Set ON time by clock, Set OFF timer by clock
  - Weekly timer
  - Outdoor unit silent mode timer
  - Filter sign reset, Setting next cleaning date

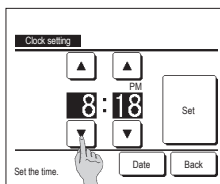

- 3 Set the "hour : minute" with the **▲** **▼** buttons on the clock setting screen.  
Tap the **Set** button after the setting.  
To change "dd/mm/yy" tap the **Date** button.

## ■ Date & time display

You can set and correct the date & time display.

- 1 Tap the **Menu** button on the TOP screen and select **User setting** ⇒ **Initial settings** ⇒ **Date & time display**.

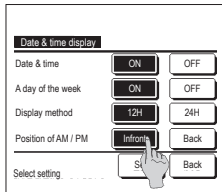

- 2 The Clock setting screen is displayed.

Tap **OFF** / **ON** for the Date and time.

Tap **OFF** / **ON** for A day of the week.

Tap Display method "12H or 24H".

**12H** Hours ... If it is 3:50 PM, it displays "3:50PM".

**24H** Hours ... If it is 3:50 PM, it displays "15:50".

Set the position of AM/PM.

Set **Infront** ... "PM3:50" is displayed.

Set **Back** ... "3:50PM" is displayed.

- 3 Tap the **Set** button after the setting.

## ■ Summer time

You can adjust the current time by one hour.

- 1 Tap the **Menu** button on the TOP screen and select **User setting** ⇒ **Initial settings** ⇒ **Summer time**.

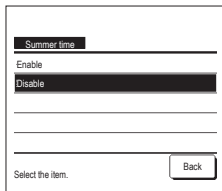

- 2 The Summer time setting screen is displayed.

Changing from **Disable** to **Enable** ... (Current time + 1 hr) is displayed.

Changing from **Enable** to **Disable** ... (Current time - 1 hr) is displayed.

## ■ Contrast

You can adjust the contrast of the LCD.

- 1 Tap the **Menu** button on the TOP screen and select **User setting** ⇒ **Initial settings** ⇒ **Contrast**.

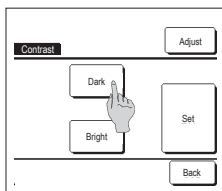

- 2 The Contrast Adjustment screen is displayed.

Tap the "Contrast" on the Initial settings menu screen. The contrast on the screen changes by tapping the **Dark** or **Bright** button to select a desired contrast.

- 3 Tap the **Set** button after the setting.

[When the contrast differs between the top and bottom of the screen]

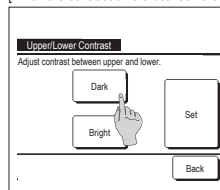

- 4 Tap the **Adjust** button to display the Upper/Lower Contrast screen.

- 5 The contrast of the lower half of the screen changes when you tap the **Dark** / **Bright** button. Adjust the contrast so that the upper and lower halves of the screen match.

- 6 After you make the settings, tap the **Set** button.

## ■ Backlight

You can turn ON/OFF the backlight and set the lighting period.

- 1 Tap the **Menu** button on the TOP screen and select **User setting** ⇒ **Initial settings** ⇒ **Backlight**.

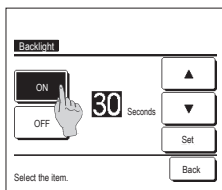

- 2 The Backlight setting screen is displayed.

Tap the ON or OFF buttons for the backlight lighting and the lighting Period (5 - 90 sec, at 5-sec intervals).

**ON** ... The "Backlight" lights when the LCD is tapped.

If no operation is made for the set time, it turns off automatically.

**OFF** ... The "backlight" does not light even if the LCD is tapped.

- 3 Tap the **Set** button after the setting.

## ■ Controller sound

You can set to have the controller sound ON/OFF when the touch panel is operated.

- 1 Tap the **Menu** button on the TOP screen and select **User setting** ⇒ **Initial settings** ⇒ **Controller sound**.

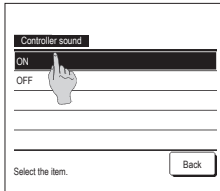

- 2 The Controller sound setting screen is displayed.

Tap ON or OFF for the controller sound.

**ON** ... When a button on the screen is tapped, a "beep" sounds.

**OFF** ... There is no beep.

## ■ Operation lamp luminance

You can adjust the operation lamp luminance.

- 1 Tap the **Menu** button on the TOP screen and select **User setting** ⇒ **Initial settings** ⇒ **Operation lamp luminance**.

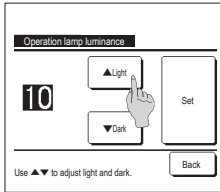

- 2 The Operation lamp luminance adjustment screen is displayed.

You can adjust the luminance of the operation lamp to a desired level by tapping the **▲Light** / **▼Dark** button.

- 3 After you make the settings, tap the **Set** button.

## Timer

### Advice

The Clock setting must be made when the Set ON timer by clock or Set OFF timer by clock is used.

- 1 Tap the **Menu** button on the TOP screen and select **Useful functions** ⇒ **Timer**.

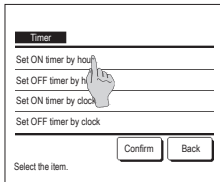

- 2 Tap a desired item on the Timer menu.

- Set ON timer by hour
- Set OFF timer by hour
- Set ON timer by clock
- Set OFF timer by clock
- Confirm

When the timer is set, the **Confirm** button is displayed.

The button is not displayed unless the timer is set.

### ■ Operation of each timer

#### • Sleep timer

Stops the operation of the unit when the amount of time set has elapsed since the start of the operation. When the setting is enabled, this timer will activate whenever any operation starts.

#### • Set ON timer by hour

When the set time elapses, the air conditioner starts.  
Operating conditions at the start of operation can be set.  
Operation takes place once at each setting.

#### • Set OFF timer by hour

When the set time elapses, the air conditioner stops.  
Operation takes place once at each setting.

#### • Set ON timer by clock

The air conditioner starts at the set time.  
Operating conditions at the start of operation can be set.  
Only one day (Once) operation or operation Everyday can be set.

#### • Set OFF timer by clock

The air conditioner stops at the set time.  
Only one day (Once) operation or operation Everyday can be set.

#### • Weekly timer

On timer and Off timer on weekly basis can be set.

Setting of each timer can be combined. Allowable combination settings are as shown below.

#### Allowable combination setting (○: Allowed, ×: Prohibited)

|            | Sleep | OFF: Hours | ON: Hours | OFF: Clock | ON: Clock | Weekly |
|------------|-------|------------|-----------|------------|-----------|--------|
| Sleep      |       | ×          | ×         | ○          | ○         | ○      |
| OFF: Hours | ×     |            | ×         | ×          | ×         | ×      |
| ON: Hours  | ×     | ×          |           | ×          | ×         | ×      |
| OFF: Clock | ○     | ×          | ×         |            | ○         | ×      |
| ON: Clock  | ○     | ×          | ×         | ○          |           | ×      |
| Weekly     | ○     | ×          | ×         | ×          | ×         |        |

If a prohibited combination setting is made, a message "The combination can't be accepted" is displayed for 3 seconds.

■ Priority order of the timer settings (①→③) is as follows.

- ① Set OFF timer by hour/clock, weekly OFF timer
- ② Sleep timer
- ③ Set ON timer by hour/clock, weekly ON timer

■ On the TOP screen, the timer is displayed from the earliest one out of OFF time of the sleep timer, ON time and OFF time.

## ■ Set ON timer by hour

When the set time elapses, the air conditioner starts.

- 1 Tap the **Menu** button on the TOP screen and select **Useful functions** ⇒ **Timer** ⇒ **Set ON timer by hour**.

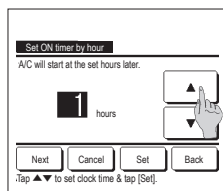

- 2 The Set ON timer by hour setting screen is displayed.  
Select desired hours for the period to start operation by timer with the **▲** **▼** buttons.  
Range of setting time: 1 to 12 hours (at 1-hr intervals)

- 3 When operating conditions at the start of operation are set, tap the **Next** button. (≡ 4)  
When operating conditions are not set, tap the **Set** button.

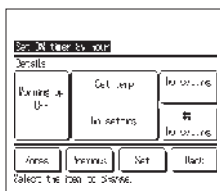

- 4 Set the following operating conditions.

① Warming up ON/OFF

(the Main R/C only)

② Operation mode ... ≡ 5

③ Set temp ... ≡ 6

④ Fan speed ... ≡ 7

⑤ Zones ... ≡ 9

■ Warming up setting can be made with the main R/C only.

■ Set the operation mode before setting the set temperature.

## Advice Warming up

· To warm up the room temperature closed to the set temperature at the set start time of the operation, the microcomputer estimates the start time of the operation based on the last warming up operation and starts the operation 5 to 60 minutes earlier.

· When the warming up is turned ON, set the timer at one hour earlier or more than the start operation by timer.

· If it is set in less than one hour, a message "Warming up cancelled" is displayed on the screen. (This is used as the Set ON timer by hour and clock.)

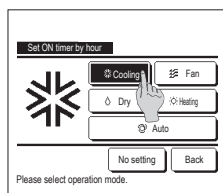

- 5 Tap a desired operation mode.  
If the **No setting** button is tapped, it starts operation at the last action. (≡ 4)

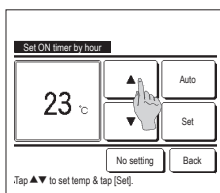

- 6 Select a desired temperature (at 1°C intervals) with the **▲** **▼** buttons. Or tap the **Auto** button and select the auto temp setting.

Tap the **Set** button after the adjustment. (≡ 4)

When the **No setting** button is tapped, "—"°C is displayed, and it starts operation at the last setting temperature.

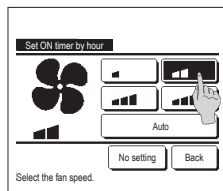

- 7 Tap a desired fan speed.  
If the **No setting** button is tapped, it operates at the last action. (≡ 4)

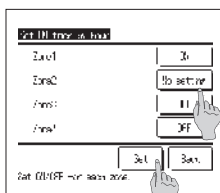

- 9 Tapping the **Zones** button makes it possible to perform zone operation settings at the time of timer working. Set **No setting** / **ON** / **OFF** (No setting/ OPEN/CLOSE) for each zone during timer operation.

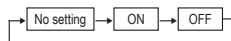

Setting **No setting** will operate in the previous zone state at the time of timer working.

After the setting, tap the **Set** button.

The display returns to the previous screen.

## ■Set OFF timer by hour

When the set time elapses, the air conditioner stops.

- 1 Tap the **Menu** button on the TOP screen and select **Useful functions** ⇒ **Timer** ⇒ **Set OFF timer by hour**.

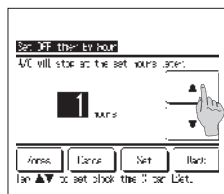

- 2 The Set OFF timer by hour setting screen is displayed.

Select desired hours to stop operation with the **▲** **▼** buttons.

Range of setting time: 1 to 12 hours (at 1-hr intervals)

- 3 The **Zones** button is displayed when performing zone settings. Tapping the **Zones** button makes it possible to perform zone operation settings at the time of timer working. (The **Zones** button is not displayed when not performing zone settings. Proceed to step 5.)

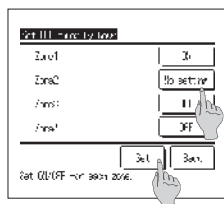

- 4 Tapping the **Zones** button will transition to the zone operation setting screen. Set **No setting** / **ON** / **OFF** (No setting/OPEN/CLOSE) for each zone during timer operation.

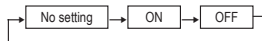

Setting **No setting** will operate in the previous zone state at the time of timer working.

After the setting, tap the **Set** button.

The display returns to the previous screen.

- 5 After the setting, tap the **Set** button. The display returns to the Timer menu screen.

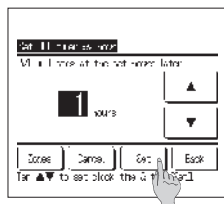

## ■Set ON timer by clock

Starts the operation of the unit at the set clock time.

- 1 Tap the **Menu** button on the TOP screen and select **Useful functions** ⇒ **Timer** ⇒ **Set ON timer by clock**.

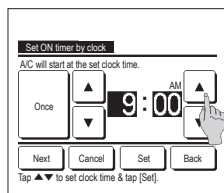

- 2 The Set OFF timer by hour setting screen is displayed.

Select a desired time to start operation (5-min intervals) with the **▲** **▼** buttons.

- 3 When operating conditions at the start of operation are set, tap the **Next** button to set operation conditions. (Step 4)

If operating conditions are not set, tap the **Set** button.

The Set ON timer by clock can be operated one day (Once) or everyday.

If it is operated everyday, tap the **Once** / **Everyday** button to change the display to "Everyday".

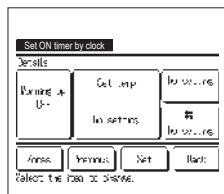

- 4 Set the following operating conditions.

① Warming up ON/OFF (the Main R/C only)

② Operation mode ... Step 5

③ Set temp ... Step 6

④ Fan speed ... Step 7

⑤ Zones ... Step 9

■ Warming up setting can be made with the main R/C only.

■ Set the operation mode before setting the set temperature.

## Advice Warming up

- To warm up the room temperature closed to the set temperature at the set start time of the operation, the microcomputer estimates the start time of the operation based on the last warming up operation and starts the operation 5 to 60 minutes earlier.
- When the warming up is turned ON, set the timer at one hour earlier or more than the start operation by timer.
- If it is set in less than one hour, a message "Warming up cancelled" is displayed on the screen. (This is used as the Set ON timer by hour and clock.)

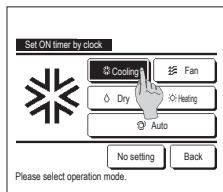

### 5 Tap a desired operation mode.

If the **No setting** button is tapped, it starts operation at the last action. (≡≡ 4)

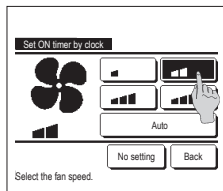

### 7 Tap a desired fan speed.

If the **No setting** button is tapped, it operates at the last action. (≡≡ 4)

### 8 After setting the desired contents at the screen of the step 4 on the previous page, tap the **Set** button.

Operation will start at set hours later.

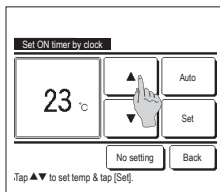

### 6 Select a desired temperature (at 1°C intervals) with the **Auto** button and select the auto temp setting.

Tap the **Set** button after the adjustment. (≡≡ 4)

When the **No setting** button is tapped, "—"°C is displayed, and it starts operation at the last setting temperature.

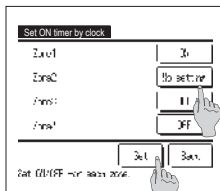

### 9 Tapping the **Zones** button makes it possible to perform zone operation settings during timer operation. Set **No setting** / **ON** / **OFF** (No setting / OPEN/CLOSE) for each zone at the time of timer working.

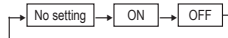

Setting **No setting** will operate in the previous zone state at the time of timer working.

After the setting, tap the **Set** button.

The display returns to the previous screen.

## ■Set OFF timer by clock

Stops the operation of the unit at the set clock time.

- 1 Tap the **Menu** button on the TOP screen and select **Useful functions** ⇒ **Timer** ⇒ **Set OFF timer by clock**.

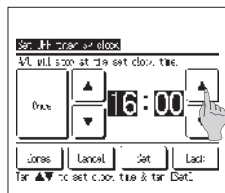

- 2 The Set OFF timer by clock setting screen is displayed.

Select a desired time to stop operation (5-min intervals) with the **▲** **▼** buttons.

- 3 The **Zones** button is displayed when performing zone settings. Tapping the **Zones** button makes it possible to perform zone operation settings at the time of timer working. (The **Zones** button is not displayed when not performing zone settings. Proceed to step 5.)

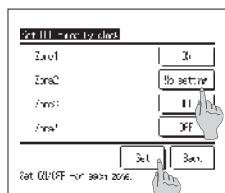

- 4 Tapping the **Zones** button will transition to the zone operation setting screen. Set **No setting** / **ON** / **OFF** (No setting/OPEN/CLOSE) for each zone at the time of timer working.

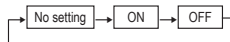

Setting **No setting** will operate in the previous zone state during timer operation.

After the setting, tap the **Set** button.

The display returns to the previous screen.

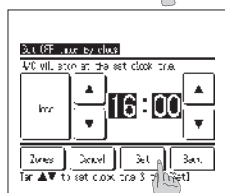

- 5 After the setting, tap the **Set** button. The display returns to the Timer menu screen.

The Set OFF timer by clock can be operated one day (Once) or everyday.

If it is operated everyday, tap the **Once** / **Everyday** button to change the display to **Everyday**.

## ■Confirm



- 1 When you tap the **Confirm** button on the Timer menu screen, the contents of the current timer settings are displayed.

■ When the warming up is set, " **W** " is displayed in front of the operation mode on confirmation screen.

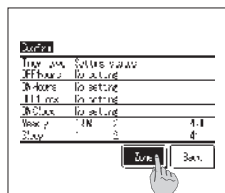

■ The **Zone** button is displayed when performing zone settings. Tapping the **Zone** button will display the set zone states.

## Weekly timer

You can set four on timer and off timer operations for each day of the week.

### Advice

- The Clock setting must be made when the weekly timer is used.
- The weekly timer can be set from the main R/C only.

1 Tap the [Menu] button on the TOP screen and select [Useful functions] ⇒ [Weekly timer].

Enter the administrator password if the administrator password input screen is displayed.

■ There are cases that the Input password screen is displayed by the Permission/Prohibition setting.

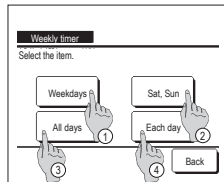

2 When the screen to select the setting range, select a day of the week to be set.

- ① Weekdays : Monday - Friday
- ② Sat. Sun : Saturday, Sunday
- ③ All days : Monday - Sunday
- ④ Each day : Moves to the day of the week setting screen. (≠ 3)

3 When a desired day of the week ① is tapped on the display, contents of current setting for the day are displayed. (≠ 5)

4 For the holiday setting, tap the block ② under the day to switch between "H" (the holiday setting) and "(Blank)" (reset).

Timer does not operate on the day set as holiday.

Two or more holidays can be set.

■ To enable the timer on the day set as holiday, it is necessary to reset the holiday setting.

When tapping ③ [All Disable] button, the timer does not operate on all days of the week.

When the timer is used, be sure not to set "All Disable".

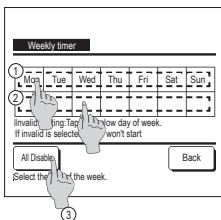

5 Screen to check contents of current setting is displayed.

When the contents are changed or new setting is added, select a ① setting line No. and tap the ② [Change] button.

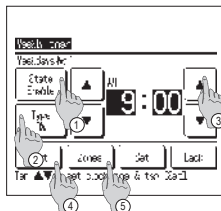
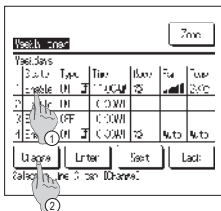

6 Detail setting screen for the timer setting contents is displayed.

① Tap the [State] button to switch between "State Enable" and "State Disable".

② Tap the [Type] button to switch between the "OFF timer" and the "ON timer".

③ Select a desired time (at 5-min intervals) with the [▲] [▼] buttons.

④ In case of "ON timer" when the [Next] button is tapped, operating conditions at the start of operation can be set. (≠ 7)

⑤ The [Zones] button is displayed when performing zone settings.

Tapping the [Zones] button will display the set zone states.

(≠ 1 2)

■ The ③ [Zone] button is displayed when performing zone settings. Tapping the ③ [Zone] button will display the set zone states.

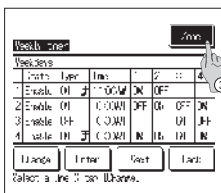

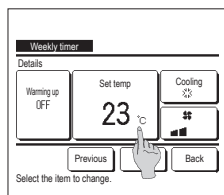

## 7 Set the following operating conditions.

- ① Warming up ON/OFF  
(Operation starts 5 to 60 minutes earlier in order to warm up the room temperature closed to the set temp at the set start time of operation.)
- ② Operation mode ...[≡](#)8
- ③ Set temp ...[≡](#)9
- ④ Fan speed ...[≡](#)10

■ Set the operation mode before setting the set temperature.

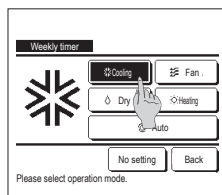

## 8 Tap a desired operation mode.

When the **No setting** button is tapped, it operates with the same operation mode at the last action. ([≡](#)7)

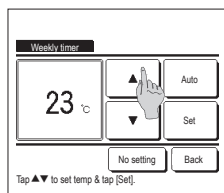

## 9 Select a desired temperature (at 1°C intervals) with the ▲▼ buttons. Or tap the Auto button to select the Auto temp setting.

Tap the **Set** button after the selection. ([≡](#)7)

When the **No setting** button is tapped, "—"°C" is displayed, and it starts operation at the last setting temperature.

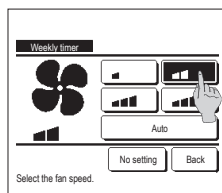

## 10 Tap a desired fan speed.

When the **No setting** button is tapped, starts operation at the last fan speed. ([≡](#)7)

## 11 After setting desired contents at the screen of 7, tap the **Set** button.

## 12 Tapping the **Zones** button will transition to the zone operation setting screen. Set **No setting** / **ON** / **OFF** (No setting/OPEN/CLOSE) for each zone at the time of timer working.

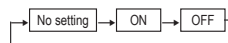

Setting **No setting** will operate in the previous zone state at the time of timer working.  
After the setting, tap the **Set** button.  
The display returns to the previous screen.

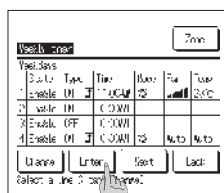

## 13 Display the setting contents check screen. To register the setting, tap the **Enter** button.

- (1) In case of group setting (2-① Weekdays, 2-② Sat/Sun, 2-③ All days setting), move to the group setting screen. ([≡](#)13)
- (2) In case of the individual setting (2-④ Each day setting), save the setting and move to a day of the week selection screen. ([≡](#)3)

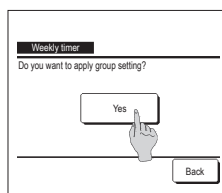

## 14 Display the group setting acknowledge screen. Tap the **Yes** button and save the setting.

The display changes to a day of the week setting check screen after saving. ([≡](#)3)

When making the setting after changing a day of the week, repeat the setting from the step 3.

## Registering favorite settings

Operation mode, set temp, fan speed, fan direction can be registered as Favorite set 1 and Favorite set 2.

Allocating these settings to the [F1] and [F2] switches allows you to perform operations with these registered settings with a single tap of the button.

Refer to the F1/F2 function setting on how to set the [F1] and [F2] switches.

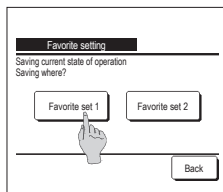

- 1 On the TOP screen, set the desired operation mode, set temp, fan speed, and flap direction.  
Tap the [Menu] button on the TOP screen and select [Useful functions] ⇒ [Favorite setting].  
The administrator password input screen is displayed.  
Enter the administrator password.  
■ You cannot register the favorite settings during high power and energy-saving operations.
- 2 The save location selection screen for favorite settings is displayed.  
Select the save location.  
If there is any data that was previously saved, that data will be overwritten.

## Favorite setting operation

You can start an operation with the operation mode, set temp, fan speed, flap direction registered to Favorite set 1 and Favorite set 2.

Settings for the operation mode, set temp, fan speed, fan speed, flap direction can be registered from Favorite setting on the menu.

Favorite setting operation must be set to the [F1] or [F2] switch.

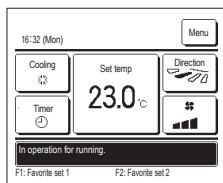

- 1 When you press the [F1] ([F2]) switch, the operation mode, set temp, fan speed, flap direction registered to Favorite set 1 or Favorite set 2 will be enabled.  
■ Operation will start even if you press the [F1] ([F2]) switch while the unit is stopped.  
■ You can change the operation mode, set temp, fan speed, flap direction after the operation has started with the favorite setting operation.  
■ Following power on, the unit starts to operate initially with the following settings for both Favorite set 1 and Favorite set 2.  

|                |               |
|----------------|---------------|
| Operation mode | ...Cooling    |
| Set temp       | ...28°C       |
| Fan speed      | ...3-speed    |
| Flap direction | ...Position 2 |

\*When an FDK with a left/right flap is connected  
 Left/right flap direction ...Center  
 3D AUTO ...Disabled

■ When Change set temp, Change operation mode, Change flap direction, Change fan speed are restricted by the Permission/Prohibition setting, restricted items will not be reflected to the favorite setting operation.

## Silent mode control

The OU is controlled with priority on quietness. You can start/stop the silent mode control.

### [Starting control with [Menu] button]

- 1 Tap the [Menu] button on the TOP screen and select [Useful functions] ⇒ [Silent mode control].  
The administrator password input screen is displayed.  
Enter the administrator password.

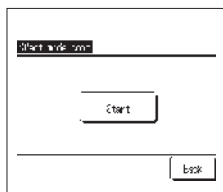

- 2 The Silent mode control (Start/End) screen is displayed.  
Tap the [Start] button to start the silent mode control.  
To terminate the silent mode control, tap the [End] button.

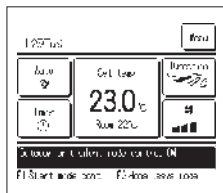

3 During silent mode control, "Outdoor unit silent mode control ON" will be displayed on the message display.

- Silent mode control will not be disabled even if you press the **Run/Stop** switch.
- When the sub R/C is set, the silent mode control cannot be used.
- During silent mode control, operation with maximum capacity is not allowed.

### [Starting control with **F1** or **F2** switch]

Change the **F1** (**F2**) switch function to the silent mode control in the **F1** (**F2**) function setting.

When you press the **F1** (**F2**) switch, the administrator password input screen is displayed. After you enter the password, the silent mode control will start.

To terminate the silent mode control, press the **F1** (**F2**) switch again.

■ This operation is to select enable/disable of silent mode control. You cannot start the operation with the **F1** (**F2**) switch during stop. Start the operation with the **Run/Stop** switch.

## Select the language

Select the language to be displayed on the R/C.

### [Selecting the language with the **Select the language** button]

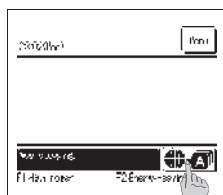

1 Tap the **Select the language** button on the TOP screen while the air conditioner is stopped.

- Depending on how the Permission/Prohibition setting (⇒ Refer to user's manual.) is set, the administrator password input screen may be displayed.

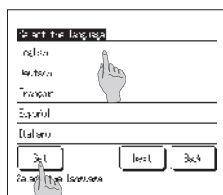

2 The menu for select the language is displayed.

Select the language to be displayed on the R/C and tap the **Set** button.

You can select from the following languages:

English/German/French/Spanish/Italian/Dutch/Turkish/Portuguese/Russian/Polish/Japanese/Chinese

### [Selecting the language with the **Menu** button]

1 Tap the **Menu** button on the TOP screen and select **Useful functions** ⇒ **Select the language**.

- Depending on how the Permission/Prohibition setting (⇒ Refer to user's manual.) is set, the administrator password input screen may be displayed.

2 The menu for setting the language selection is displayed.

Select a language to be displayed on the R/C and tap the **Set** button.

## 6. Maintenance and After-sale service

### Filter sign reset

In order to announce the time for cleaning of the air filter, the message of "Filter cleaning. Touch here." is displayed when the cumulative operation time of the IU reaches the preset time. After you clean the filter, you must reset the operation time.

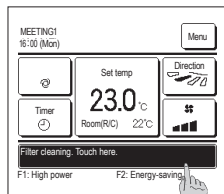

- 1 Tap the message display on the TOP screen.

You can also perform filter sign reset from the menu before the message "Filter cleaning. Touch here." is displayed.

Tap the **Menu** button on the TOP screen and select **Filter** ⇒ **Filter sign reset**.

You can also use the **F1** and **F2** switches to perform this operation.

Set the filter sign reset to the **F1** (**F2**) switch using the Switch function to perform this operation.

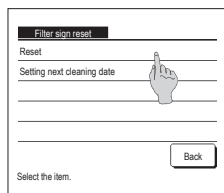

- 2 The filter sign reset menu screen is displayed.

To reset the filter sign, tap **Reset**.

(≠ 3)

To set next cleaning date, tap **Setting next cleaning date**. (≠ 4)

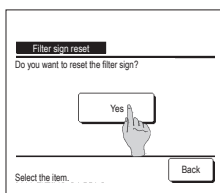

- 3 Acknowledge screen for the Filter sign reset screen is displayed.

Tap the **Yes** button.

If you do not want to reset, tap the **Back** button.

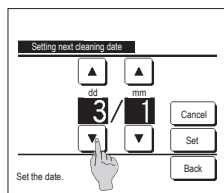

- 4 The Setting next cleaning date screen is displayed.

Select a desired date with the **▲** **▼** buttons and tap the **Set** button.

The message of "Filter cleaning. Touch here." will be displayed on the set date.

#### Advice

When setting next cleaning date, the Clock setting must be made.

### Maintenance of unit and LCD

■ Wipe the surface of LCD and main body of the remote control with a dry cloth when cleaning is required.

■ If the dirt on the surface cannot be removed, soak the cloth in neutral detergent diluted with water, squeeze the cloth tightly, and clean the surface. Wipe the surface with a dry cloth then.

#### Note

Do not use any paint thinner, organic solvent, or strong acid.

### Warning



**Do not use flammable materials (e.g. hairspray or insecticide) near the unit.**

**Do not clean the unit with benzene or paint thinner.**

It could cause crack damage to the unit, electric shocks, or fire.

## Contact company & Error display

If any error occurs on the air conditioner, the "Unit protection stop" is indicated on the message display. Take the following measures, stop the operation and consult your dealer.

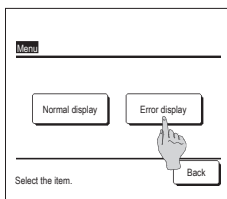
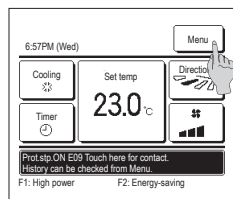

**1** The "Unit protection stop" is displayed on the message display.

Tap the **Menu** button.

When the **Normal display** and **Error display** button is displayed, tap the **Error display** button.

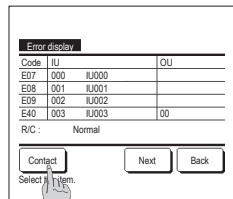

**2** Contents of error are displayed.

After checking the error contents

(Code), tap the **Contact** button.

Or tap the **Normal display** button on the previous screen and select the "Contact company" on the menu screen and tap it.

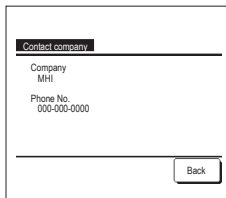

**3** Company information (Name and phone No. of contact) is displayed.

This is displayed when it has been preset by your dealer.

## Notice of inspection date

If the next service date is set on the Service & Maintenance menu by your dealer, the following screen is displayed for 5 seconds at the start of operation and for 20 seconds from the end of operation on the beginning of the month which includes the set date.

When this screen is displayed, contact your dealer.

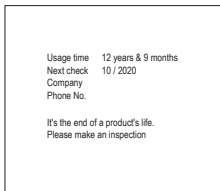
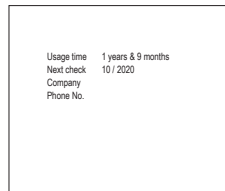

When the period of use exceeds 10 years, the screen shown at left is displayed.

When this screen is displayed, contact your dealer.

## After-sale service

### ● Inform your dealer

- Model name
- Date of installation
- Failure conditions: As precise as possible.
- Your address, name, and telephone number

### ● Moving

The moving of the unit requires special technology. Consult your dealer.  
Necessary expenses for the moving of the unit will be charged.

### ● Repairs after Warranty Period

Consult your dealer. Fare-paying services may be possible at the request of customer.  
(The warranty period is one year counting from the date of installation.)

### ● Inquiry about After-sale Service

Contact your dealer or the service contact.







---

**mitsubishi heavy industries thermal system, ltd.**

16-5, Konan 2-chome, Minato-ku, Tokyo, 108-8215, Japan  
<http://www.mhi-mth.co.jp>

**mitsubishi heavy industries air-conditioning europe, ltd.**

5 The Square, Stockley Park, Uxbridge, Middlesex UB11 1ET, United Kingdom  
Tel : +44-333-207-4072  
Fax : +44-333-207-4089  
<http://www.mhiaa.com>

**mitsubishi heavy industries air - conditioners australia, pty. ltd.**

Building E, 391 Park Road, REGENTS PARK NSW 2143  
Tel : +61-2-8774-7500  
Fax : +61-2-8774-7501  
<http://www.mhiaa.com.au>

**mitsubishi heavy industries - mahajak air conditioners co., ltd.**

220, Soi Chalongkrung 31,  
Kwang Lamplatiew, Khet Lad Krabang, Bangkok 10520, Thailand  
Tel : +66-2-326-0401  
Fax : +66-2-326-0419  
<http://www.maco.co.th/>